

Epson WorkForce WF-3010DW

DATASHEET / BROCHURE



The ideal printer for small offices with Wi-Fi and Ethernet connectivity, speciality media feed and duplex printing

Specially designed for small offices, this printer provides reliable, flexible printing with fast print speeds and Wi-Fi and Ethernet connectivity.

Thanks to Epson's fast drying DURABrite Ultra Ink, business documents are water, smudge and highlighter resistant. Cartridges are also available in XL size, helping to save further on costs. XL inks are ideal for high print volumes, offering up to a 50 percent lower cost-per-page than competitive lasers*1.

Business-quality printing at up to 15ppm for single-sided documents and 7.9ppm for double-sided documents*2 ensure work is delivered quickly and efficiently every time.

This printer allows users to load up to 250 sheets of A4 plain paper. It has a single-sheet rear-feed paper tray providing media flexibility, accepting varied paper types and thicknesses, such as card, envelopes and business cards.

KEY FEATURES

- **Fast print speeds**
Print up to 15 pages per minute*2
- **Duplex printing**
Printing on both sides
- **Flexible connectivity**
Wi-Fi and Ethernet
- **Flexible printing**
Speciality media feed
- **Large paper tray**
250-sheet capacity tray

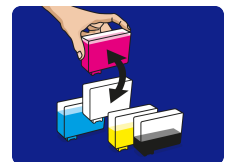

PRODUCT SPECIFICATIONS

TECHNOLOGY

Printing Method	4-colour inkjet printer
Minimum Droplet Size	2 pl, With Variable-Sized Droplet Technology
Ink Technology	DURABrite™ Ultra
Nozzle Configuration	384 Nozzles Black, 128 Nozzles per Color
Category	Office Desktop

PRINT

Printing Speed ISO/IEC 24734	15 pages/min Monochrome, 9.2 pages/min Colour
Duplex Printing Speed ISO/IEC 24734	7.9 A4 Pages/min Monochrome, 5.7 A4 Pages/min Colour
Maximum Printing Speed	38 pages/min Monochrome (plain paper 75 g/m ²), 38 pages/min Colour (plain paper 75 g/m ²)
Printing Resolution	5,760 x 1,440 DPI
Printing Volume	12,000 pages per month

The maximum number of printed pages per month based on the performance capabilities of the printer, including ISO rated print speeds and paper handling capabilities.

Colours Black, Cyan, Yellow, Magenta

For detailed information on printing speeds please visit <http://www.epson.eu/testing>.

PAPER / MEDIA HANDLING

Paper Formats	A4 (21.0x29.7 cm), A5 (14.8x21.0 cm), A6 (10.5x14.8 cm), B5 (17.6x25.7 cm), C4 (Envelope), C6 (Envelope), DL (Envelope), No. 10 (Envelope), Letter, Letter Legal, 10 x 15 cm, 13 x 18 cm, 16:9, User defined
Duplex	Yes
Paper Tray Capacity	250 Sheets Standard, 251 Sheets Maximum
Number of paper trays	1

CONNECTIVITY

Interfaces	Hi-Speed USB - compatible with USB 2.0 specification, Ethernet interface (100 Base-TX / 10 Base-T), Wireless LAN IEEE 802.11b/g/n
WLAN Security	WEP 64 Bit, WEP 128 Bit, WPA PSK (TKIP), WPA PSK (AES)

GENERAL

Energy Use	2 Watt (sleep mode), 17 Watt (Printing)
Product dimensions	449 x 380 x 165 mm (Width x Depth x Height)
Product weight	5.3 kg
Compatible Operating Systems	Mac OS 10.5.8 or later, Windows 7, Windows Vista, Windows XP, Windows XP x64

OTHER FEATURES

Emulations	ESC/P-R
------------	---------

OTHER

Warranty	12 months Carry in Optional warranty extension available
----------	---

LOGISTICS INFORMATION

SKU	C11CC34301
EAN code	8715946517032
Country of Origin	Indonesia
Layer	2 Units
Layer Block	4 Units

Better Products
for a Better Future
<http://eco.epson.com>



® CoverPlus

For more information please contact:

Home users: 0343 90 37766
Business users*: 0871 42 37766
Republic of Ireland: 01 436 7742
Or visit us at <https://www.epson.co.uk/contactus>
* 10p per minute plus network extras.

Web: www.epson.co.uk
www.epson.ie

Trademarks and registered trademarks are the property of Seiko Epson Corporation or their respective owners. Product information is subject to change without prior notice.

Epson WorkForce WF-3010DW

WHAT'S IN THE BOX

- Driver and utilities (CD)
- Individual Ink Cartridges
- Installation/safety manual
- Main unit
- Power cable
- Setup guide
- User manual (CD)
- Warranty document

INK YIELD DATA



Apple T1294 Stag T1304

●	385 pages*	945 pages*
●	474 pages*	765 pages*
●	378 pages*	600 pages*
●	616 pages*	1,005 pages*

* Approx. page yield based on ISO/IEC 24711/24712 or ISO/IEC 29102/29103. Actual yield will vary depending on images printed and usage conditions. For more information visit <http://www.epson.eu/pageyield>

1. For more information, please visit www.epson.eu/inkjetsaving

EPSON®