

# ViewSonic®



---

## **PLED-W600/PLED-W800**

### **LED Projector**

### **User Guide**

---

**IMPORTANT:** Please read this User Guide to obtain important information on installing and using your product in a safe manner, as well as registering your product for future service. Warranty information contained in this User Guide will describe your limited coverage from ViewSonic Corporation, which is also found on our web site at <http://www.viewsonic.com> in English, or in specific languages using the Regional selection box in the upper right corner of our website. "Antes de operar su equipo lea cuidadosamente las instrucciones en este manual"

---

Model No. VS15897/VS15898

## Thank you for choosing ViewSonic

With over 25 years as a world leading provider of visual solutions, ViewSonic is dedicated to exceeding the world's expectations for technological evolution, innovation, and simplicity. At ViewSonic, we believe that our products have the potential to make a positive impact in the world, and we are confident that the ViewSonic product you have chosen will serve you well.

Once again, thank you for choosing ViewSonic !



# Compliance Information

## FCC Compliance Statement

This device complies with part 15 of FCC Rules. Operation is subject to the following two conditions: (1) this device may not cause harmful interference, and (2) this device must accept any interference received, including interference that may cause undesired operation.

This equipment has been tested and found to comply with the limits for a Class B digital device, pursuant to part 15 of the FCC Rules. These limits are designed to provide reasonable protection against harmful interference in a residential installation. This equipment generates, uses, and can radiate radio frequency energy, and if not installed and used in accordance with the instructions, may cause harmful interference to radio communications. However, there is no guarantee that interference will not occur in a particular installation. If this equipment does cause harmful interference to radio or television reception, which can be determined by turning the equipment off and on, the user is encouraged to try to correct the interference by one or more of the following measures:

- Reorient or relocate the receiving antenna.
- Increase the separation between the equipment and receiver.
- Connect the equipment into an outlet on a circuit different from that to which the receiver is connected.
- Consult the dealer or an experienced radio/TV technician for help.

**Warning:** You are cautioned that changes or modifications not expressly approved by the party responsible for compliance could void your authority to operate the equipment.

## Industry Canada Statement

CAN ICES-3 (B)/NMB-3(B)

## CE Conformity for European Countries



The device complies with the EMC Directive 2004/108/EC and Low Voltage Directive 2006/95/EC.

### Following information is only for EU-member states:

The mark is in compliance with the Waste Electrical and Electronic Equipment Directive 2002/96/EC (WEEE).

The mark indicates the requirement NOT to dispose the equipment including any spent or discarded batteries or accumulators as unsorted municipal waste, but use the return and collection systems available.



If the batteries, accumulators and button cells included with this equipment, display the chemical symbol Hg, Cd, or Pb, then it means that the battery has a heavy metal content of more than 0.0005% Mercury or more than, 0.002% Cadmium, or more than 0.004% Lead.



## Declaration of RoHS2 Compliance

This product has been designed and manufactured in compliance with Directive 2011/65/EU of the European Parliament and the Council on restriction of the use of certain hazardous substances in electrical and electronic equipment (RoHS2 Directive) and is deemed to comply with the maximum concentration values issued by the European Technical Adaptation Committee (TAC) as shown below:

Substance	Proposed Maximum Concentration	Actual Concentration
Lead (Pb)	0.1%	< 0.1%
Mercury (Hg)	0.1%	< 0.1%
Cadmium (Cd)	0.01%	< 0.01%
Hexavalent Chromium (Cr <sup>6+</sup> )	0.1%	< 0.1%
Polybrominated biphenyls (PBB)	0.1%	< 0.1%
Polybrominated diphenyl ethers (PBDE)	0.1%	< 0.1%

Certain components of products as stated above are exempted under the Annex III of the RoHS2 Directives as noted below:

Examples of exempted components are:

1. Mercury in cold cathode fluorescent lamps and external electrode fluorescent lamps (CCFL and EEFL) for special purposes not exceeding (per lamp):
  - (1) Short length ( $\leq 500$  mm): maximum 3.5 mg per lamp.
  - (2) Medium length ( $> 500$  mm and  $\leq 1,500$  mm): maximum 5 mg per lamp.
  - (3) Long length ( $> 1,500$  mm): maximum 13 mg per lamp.
2. Lead in glass of cathode ray tubes.
3. Lead in glass of fluorescent tubes not exceeding 0.2% by weight.
4. Lead as an alloying element in aluminium containing up to 0.4% lead by weight.
5. Copper alloy containing up to 4% lead by weight.
6. Lead in high melting temperature type solders (i.e. lead-based alloys containing 85% by weight or more lead).
7. Electrical and electronic components containing lead in a glass or ceramic other than dielectric ceramic in capacitors, e.g. piezoelectronic devices, or in a glass or ceramic matrix compound.

## Indian Restriction of Hazardous Substances

Restriction on Hazardous Substances statement (India) This product complies with the "India E-waste Rule 2011" and prohibits use of lead, mercury, hexavalent chromium, polybrominated biphenyls or polybrominated diphenyl ethers in concentrations exceeding 0.1 weight % and 0.01 weight % for cadmium, except for the exemptions set in Schedule 2 of the Rule.

# Important Safety Instructions

1. Read these instructions.
2. Keep these instructions.
3. Heed all warnings.
4. Follow all instructions.
5. Do not use this unit near water.
6. Clean with a soft, dry cloth.
7. Do not block any ventilation openings. Install the unit in accordance with the manufacturer's instructions.
8. Do not install near any heat sources such as radiators, heat registers, stoves, or other devices (including amplifiers) that produce heat.
9. Do not defeat the safety purpose of the polarized or grounding-type plug. A polarized plug has two blades with one wider than the other. A grounding type plug has two blades and a third grounding prong. The wide blade and the third prong are provided for your safety. If the provided plug does not fit into your outlet, consult an electrician for replacement of the obsolete outlet.
10. Protect the power cord from being walked on or pinched particularly at plugs. Convenience receptacles and the point where they exit from the unit. Be sure that the power outlet is located near the unit so that it is easily accessible.
11. Only use attachments/accessories specified by the manufacturer.
12. Use only with the cart, stand, tripod, bracket, or table specified by the manufacturer, or sold with the unit. When a cart is used, use caution when moving the cart/unit combination to avoid injury from tipping over.
13. Unplug this unit when unused for long periods of time.
14. Refer all servicing to qualified service personnel. Servicing is required when the unit has been damaged in any way, such as: if the power-supply cord or plug is damaged, if liquid is spilled onto or objects fall into the unit, if the unit is exposed to rain or moisture, or if the unit does not operate normally or has been dropped.



# Copyright Information

Copyright © ViewSonic Corporation, 2014. All rights reserved.

Macintosh and Power Macintosh are registered trademarks of Apple Inc.

Microsoft, Windows, and the Windows logo are registered trademarks of Microsoft Corporation in the United States and other countries.

ViewSonic and the three birds logo are registered trademarks of ViewSonic Corporation.

VESA is a registered trademark of the Video Electronics Standards Association.

DPMS and DDC are trademarks of VESA.

PS/2, VGA and XGA are registered trademarks of International Business Machines Corporation.

Disclaimer: ViewSonic Corporation shall not be liable for technical or editorial errors or omissions contained herein; nor for incidental or consequential damages resulting from furnishing this material, or the performance or use of this product.

In the interest of continuing product improvement, ViewSonic Corporation reserves the right to change product specifications without notice. Information in this document may change without notice.

No part of this document may be copied, reproduced, or transmitted by any means, for any purpose without prior written permission from ViewSonic Corporation.

# Product Registration

To fulfill possible future product needs, and to receive additional product information as it becomes available, please visit your region section on ViewSonic's website to register your product online.

The ViewSonic CD also provides an opportunity for you to print the product registration form. Upon completion, please mail or fax to a respective ViewSonic office. To find your registration form, use the directory “:\CD\Registration”.

Registering your product will best prepare you for future customer service needs.

Please print this user guide and fill the information in the “For Your Records” section.

For additional information, please see the “Customer Support” section in this guide.

## For Your Records

<b>Product Name:</b>	PLED-W600/PLED-W800 ViewSonic LED Projector
<b>Model Number:</b>	VS15897/VS15898
<b>Document Number:</b>	PLED-W600/PLED-W800_UG_ENG Rev. 1A 08-25-14
<b>Serial Number:</b>	_____
<b>Purchase Date:</b>	_____

### Product disposal at end of product life

The lamp in this product contains mercury which can be dangerous to you and the environment. Please use care and dispose of in accordance with local, state or federal laws.

ViewSonic respects the environment and is committed to working and living green.

Thank you for being part of Smarter, Greener Computing.

Please visit ViewSonic website to learn more.

USA & Canada: <http://www.viewsonic.com/company/green/recycle-program/>

Europe: <http://www.viewsoniceurope.com/uk/support/recycling-information/>

Taiwan: <http://recycle.epa.gov.tw/recycle/index2.aspx>

# Table of Contents

## Introduction 7

Package Overview .....	7
Product Overview .....	8
Remote Control .....	9

## Installation 10

Power On/Off.....	10
Adjust Projected Image Height.....	10
Adjust the Projected Image .....	11
Connect Input Source - HDMI/MHL or COMPUTER.....	12
Connect Input Source - Composite AV IN (PLED-W800 only).....	13
Insert SD Card (PLED-W800 only).....	13
Insert USB Flash Drive (PLED-W800 only) .....	14
Mount the Projector .....	14

## Using Multimedia Menu (PLED-W800 only) 15

How to Use the Multimedia Menu .....	15
Viewing Photos.....	17
Photo Settings .....	18
Playing Videos.....	19
Video Settings .....	20
Playing Music .....	21
Music Settings .....	22
Viewing Documents.....	23

Viewing System Settings .....	24
USB Display .....	25
Wi-Fi Display .....	26
Configure Wireless Connection (via AP mode).....	27
Configure Wireless Connection (via Client mode) .....	28
Media Streaming .....	29
Screen Mirroring.....	30
Adjust Menu Settings for External Input Source .....	31
Using the Main Menu .....	33

## Appendix 35

Media File Support List (PLED-W800 only) .....	35
Specifications .....	40
Troubleshooting.....	41



# Introduction

## Package Overview

Unpack and inspect the box contents to ensure all parts listed below are in the box. If something is missing, please contact our customer service.

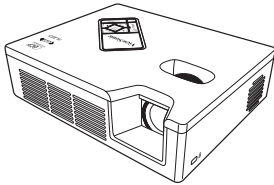

Projector

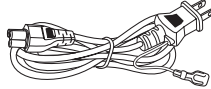

AC Power Cord

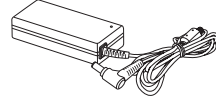

AC Power Adapter



HDMI Cable

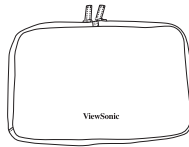

Soft Carrying Bag



Remote Control (with batteries)



Quick Start Guide



CD-ROM (User's Guide)



- Due to different applications in each Country, some regions may have different accessories.
- Make sure to properly discard the used batteries according to local regulations.



# Product Overview

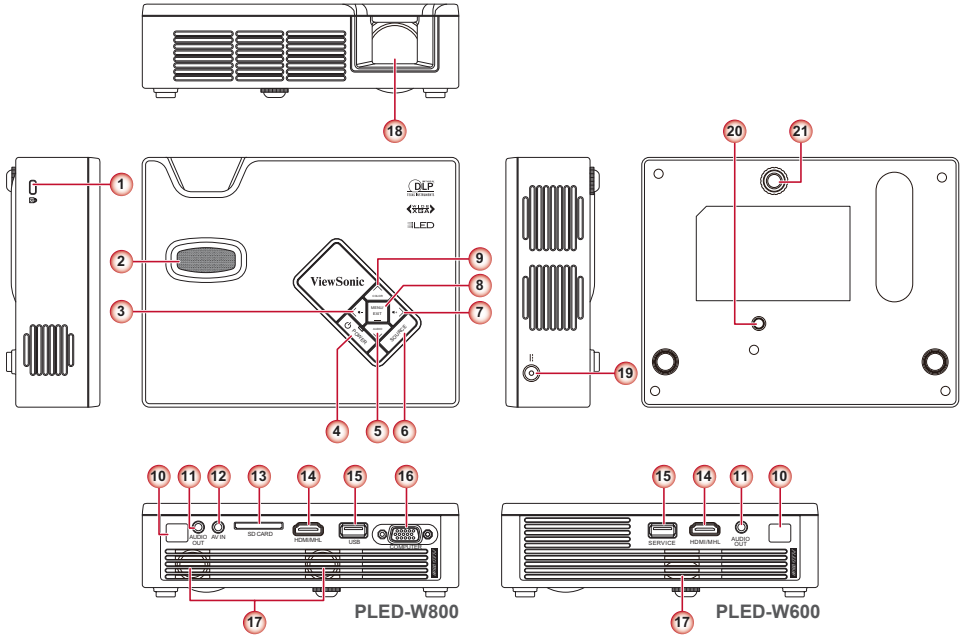

- |                                    |                           |
|------------------------------------|---------------------------|
| 1. Kensington Lock                 | 12. A/V Input Connector   |
| 2. Focus Dial                      | 13. SD Card Slot          |
| 3. Left Button / Audio - (<)       | 14. HDMI/MHL Connector    |
| 4. Power Button (⏻)                | 15. USB Connector         |
| 5. Down Button / Audio mode (▼)    | 16. COMPUTER Connector    |
| 6. Source Button ( <b>SOURCE</b> ) | 17. Speaker               |
| 7. Right Button / Audio + (>)      | 18. Lens                  |
| 8. Menu Button ( <b>MENU</b> )     | 19. DC Input              |
| 9. Up Button / Color mode (▲)      | 20. Screw Hole for Tripod |
| 10. IR Receiver                    | 21. Elevator Foot         |
| 11. Audio Output Connector         |                           |



■ Items 3,5, 7~9 are also function buttons. Functions vary depending on the current mode.

# Remote Control

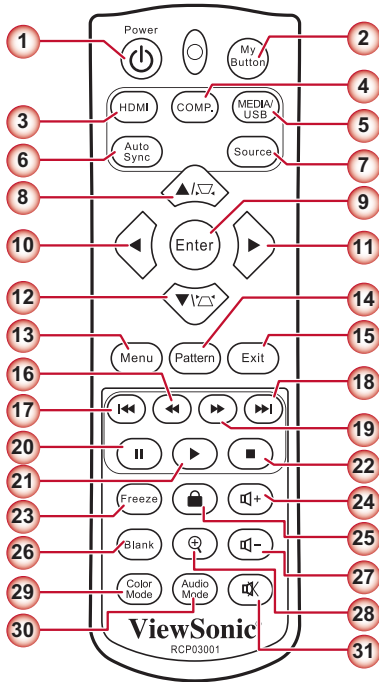

1. Power
2. My Button
3. HDMI\*
4. Computer\*
5. Media/USB\*
6. Auto Sync\*
7. Source\*
8. Up / Keystone  $\nabla$
9. Enter
10. Left
11. Right
12. Down / Keystone  $\nabla$
13. Menu
14. Pattern
15. Exit
16. Rewind\*
17. Previous\*
18. Next\*
19. Fast Forward\*
20. Pause\*
21. Play\*
22. Stop\*
23. Freeze
24. Volume +
25. Keypad Lock
26. Blank
27. Volume -
28. Magnify +/-
29. Color Mode
30. Audio Mode
31. Mute



- Buttons that marked with "\*" only work on PLED-W800 projector only.

# Installation

## Power On/Off

1. Connect the power cord to the DC input jack of the projector.

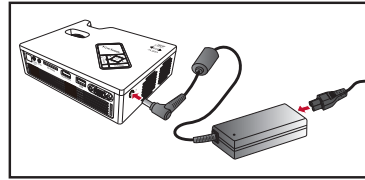

2. Inset the plug at the end of the power cord into a power outlet. The status LED lights red in standby mode.

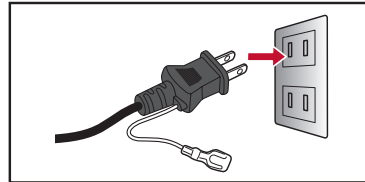

3. Press the **Power** button (⏻) to turn the projector on or off. The status LED turns green when the projector is turned on.

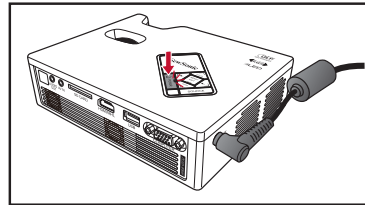

## Adjust Projected Image Height

The projector is equipped with an elevator foot for adjusting the projected image height.

To adjust the height:

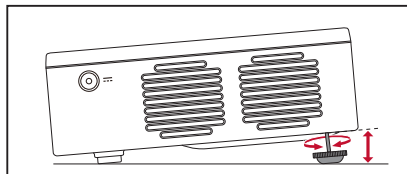

Turn the elevator foot to adjust the projected image position to the desired height.



- *If Auto Keystone is enabled and there are no changes within 2-3 seconds, the projector will automatically adjust the image display via the Auto Keystone function.*

# Adjust the Projected Image

SCREEN SIZE 16:10 Screen		PROJECTION DISTANCE	
(D)		(A)	
(inch)	(meter)	(inch)	(meter)
24	0.61	28.5	0.72
32	0.81	38.0	0.96
40	1.02	47.5	1.21
48	1.22	57.0	1.45
56	1.42	66.5	1.69
64	1.63	76.0	1.93
72	1.83	85.5	2.17
80	2.03	95.0	2.41
100	2.54	118.7	3.02

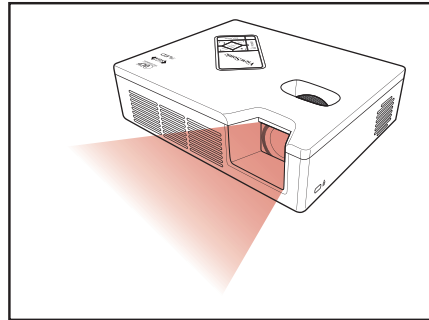
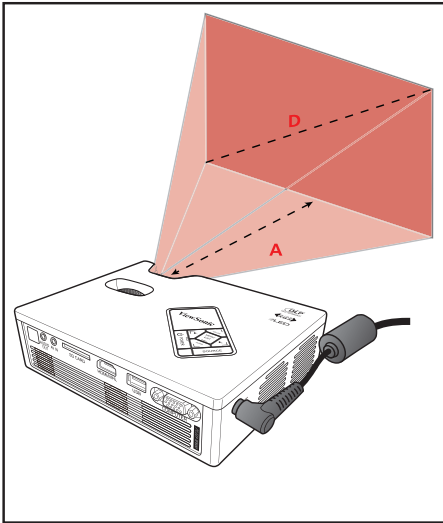

Adjust the focus until the image is clear.

# Connect Input Source - HDMI/MHL or COMPUTER

## HDMI/MHL Connection

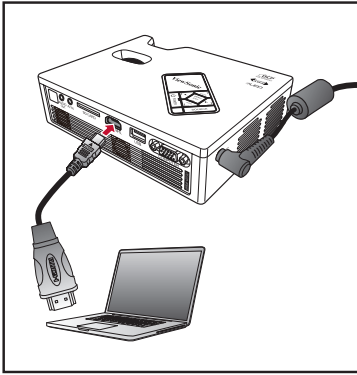

Connect to Notebook/Computer

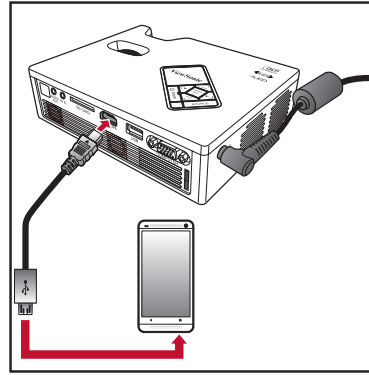

Connect to Mobile Devices

## COMPUTER Connection (PLED-W800 only)

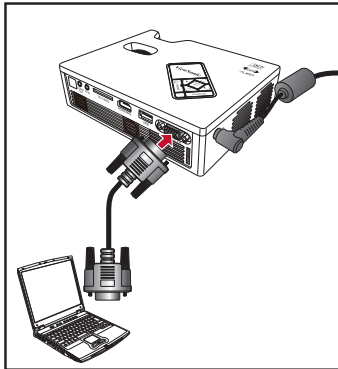

Connect to Notebook/Computer

1. Connect the COMPUTER / HDMI device using an appropriate cable.
2. After powering on the projector, press the **SOURCE** button on the control panel or the **HDMI/COMP.** button on the remote control to select the appropriate input source.

# Connect Input Source - Composite AV IN (PLED-W800 only)

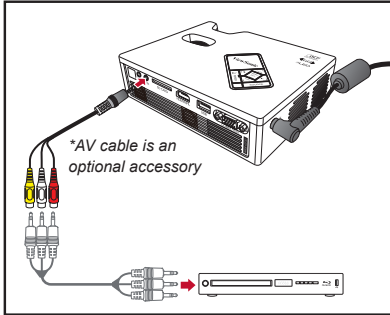

Connect to DVD player

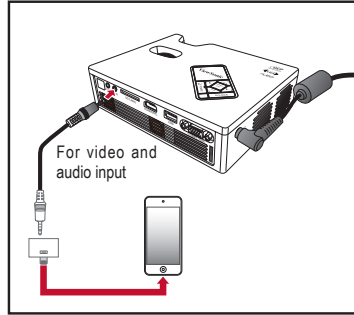

Connect to iPod Touch 5

1. Connect the AV input source.
2. After powering on the projector, press the **SOURCE** button on the control panel to select the appropriate input source.

## Audio/Video Cable Specifications

PIN	Signal
1	CVBS
2	GND
3	Audio (Right)
4	Audio (Left)



- All other brand and product names are trademarks or registered trademarks of their respective companies.
- The cables connecting the video output devices are not supplied, please contact the device vendor.
- iPod nano/iPod touch/iPhone/iPod classic (version 5 and above).
- Designed for iPod/iPhone/Smart Phone/PMP with TV out functions. Using with devices with audio signal voltage > 0.3Vrms is not recommended.
- Composite mode only supports video input source.

# Insert SD Card (PLED-W800 only)

Insert an SD card into the slot with the gold contacts facing down.

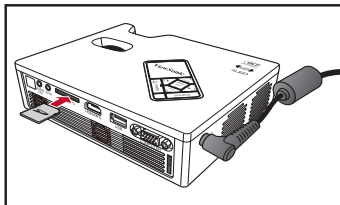

- To remove the SD card, simply pull out the memory card from the slot.
- Do not remove the SD card while the projector is projecting images from the card. This can cause data loss or damage the card.
- Supports SD card size up to 32GB.
- The SD card is not included in the package.

## Insert USB Flash Drive (PLED-W800 only)

Plug a USB flash drive into the USB connector at the back of projector.

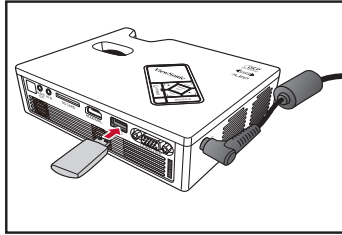

NOTE

- Supports USB flash drive with FAT32 and NTFS formats.

## Mount the Projector

Screw a standard tripod into the screw hole on the projector.

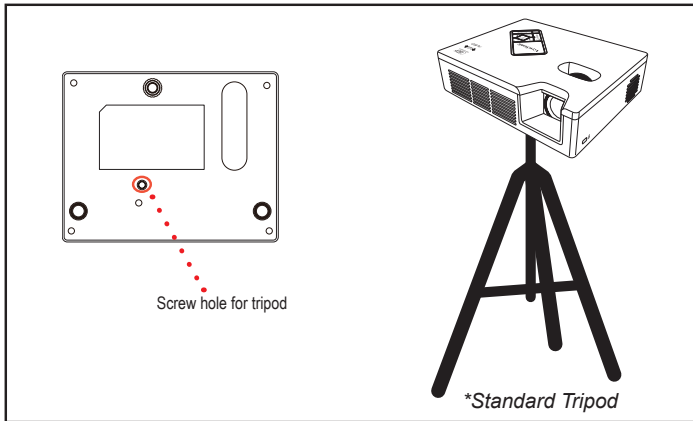

NOTE

- The tripod is an optional accessory.



# Using Multimedia Menu (PLED-W800 only)

## How to Use the Multimedia Menu

### Remote Control

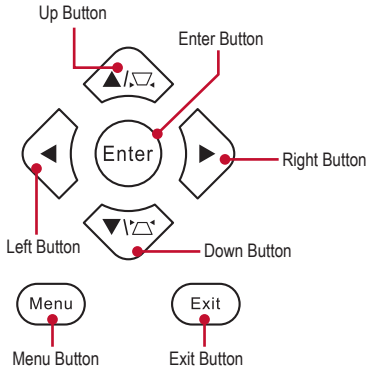

### Home menu

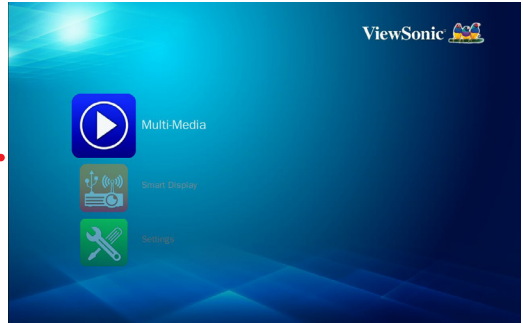

Press ▲/▼ to select the menu item that you want to access and press **Enter/▶** to enter the menu screen.

### Control Panel

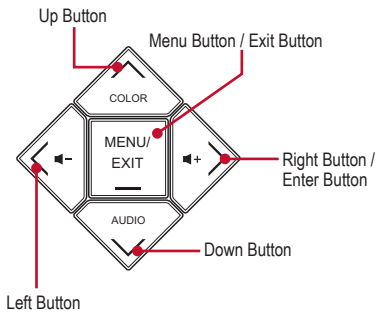

### Note

A button guide appears on the bottom of most screens. The guide varies depending on the current mode. Press the corresponding button to select the option or operation.

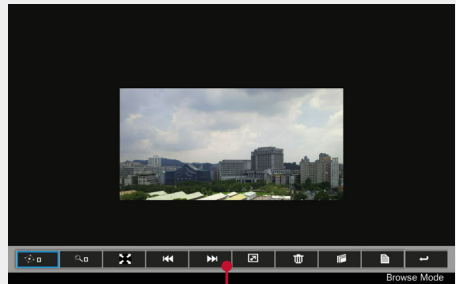

Button Guide

### General operation (i.e. using the Remote control)

- To enter Home Menu, use the **Source** button to change sources until Media/USB is reached.
- Use ▲/▼ to highlight the desired main menu option and press **Enter/▶** to confirm the selection.
- To playback media files, press ▲/▼ to select [Multi-Media] and press **Enter/▶** to enter the data source mode. Then press ▲/▼ to select the desired data source and press **Enter/▶** to enter the Multi-Media submenu.
- Buttons functionality varies depending on the current mode.

## Multi-Media submenu



Photo menu

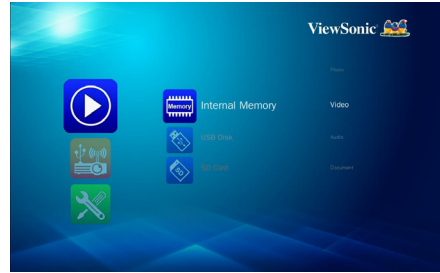

Video menu

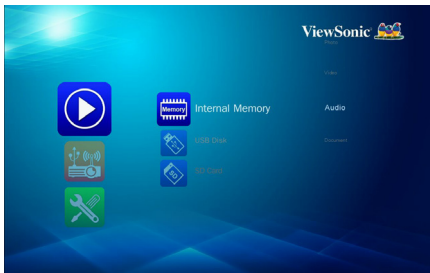

Audio menu



Document menu

## Internal Memory

Internal Memory is a form of computer data storage.

### File Transfer

File Transfer can transfer your computer's data to the projector's internal memory by using a single USB cable (A type to A type). Your computer will detect the projector's "Internal Memory" as a storage device.

1. In Multi-Media mode, select **Smart Display > USB Display**. Refer to "USB Display" on page 25.
2. Connection: Connect the USB cable to the USB A type of projector and USB type A of the computer.
3. After the projector's memory is recognized by your computer, you can move your mouse to your movie/music/file to the projector's memory.

# Viewing Photos

To view photos from the USB flash drive or SD card, do the following:

## Enter Home Menu

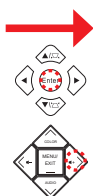
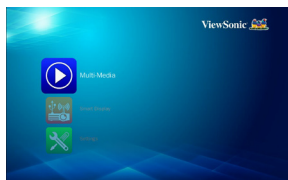

## Select Data Source



Change data source



## Select [Photo]

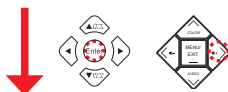
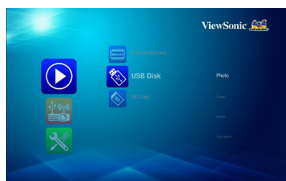

## Select Photo File

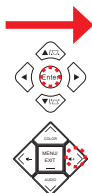
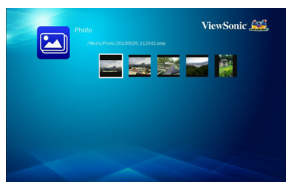
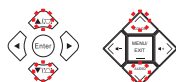

## Preview File



## Full Screen mode

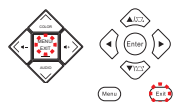

- The displayed screen may vary depending on the data source selected in the previous step.
- You can also press ▶ on the remote control to enter the submenu or confirm the selection.

## Full Screen Display

If the slide show function is enabled, photos are played continuously at specified intervals.



- The button guide disappears when the keypad is not used for 3 seconds. To display the button guide, press any key.
- To change the slideshow settings, see Photo Settings below.
- Use ◀▶ to navigate between the button options.
- Press **Enter** to select the menu item.
- Press **Exit** to return thumbnail view.

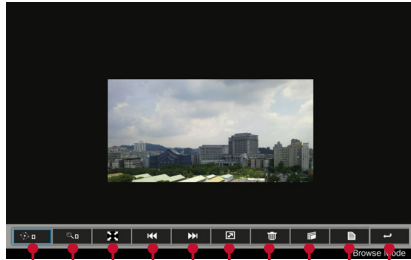

- Rotate
- Zoom
- Full screen
- Previous photo
- Next photo
- Start slideshow
- Delete
- Copy
- Return to thumbnail display
- Photo properties

## Photo Settings

### Enter Home Menu

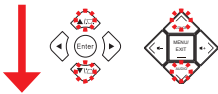
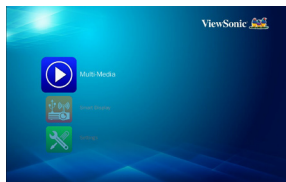

### Select [Settings]

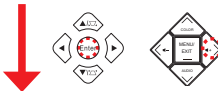
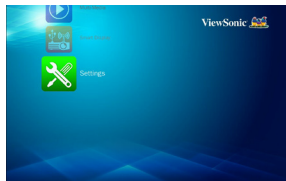

### Enter Settings Menu

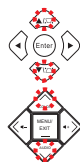
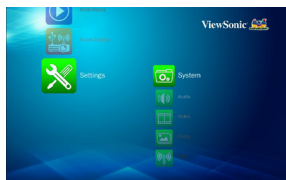

### Select [Photo]

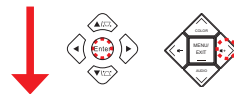
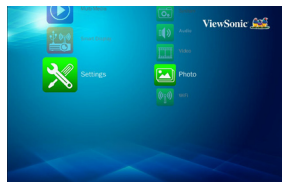

### Adjust Settings

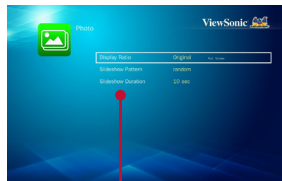

- ▲▼: Select item
- ◀▶: Adjust settings

Menu item	Description and Available Options	
Display Ratio	Select the aspect ratio of the display.	
	Available options: Full Screen / Original	
Slideshow Pattern	Select the slideshow transition effect.	
	Available options: random / Ring Diffusion / Middle Enlarge / Expand Blink / Window Shades / Linear Interaction / Cross Interleaved / Banding Alternate / Rectangle Enlarge	
	Slideshow Duration	Select the interval time between each slide displays.
	Available options: 10 sec / 30 sec / 1 min	

# Playing Videos

To play videos from the USB flash drive or SD card, do the following:

## Enter Home Menu

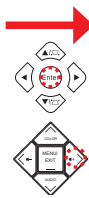
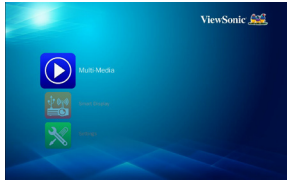

## Select Data Source



Change data source

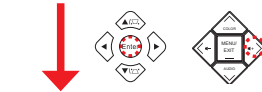

## Select [Video]

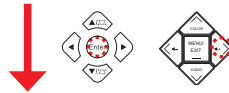

## Select Video File

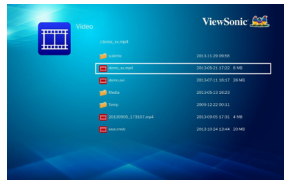
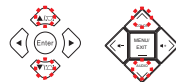

## Playback File

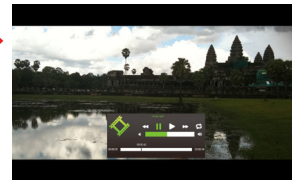

Video Playback mode

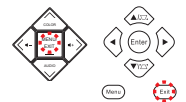

- The displayed screen may vary depending on the data source selected in the previous step.
- You can also press ► on the remote control to enter the submenu or confirm the selection.

## Video Playback Mode



- The button guide disappears when the keypad is not used for 3 seconds. To display the button guide, press any key.
- During video playback, press ◀/▶ on the remote control or </> on the control panel to adjust the volume.
- Press **Enter** to select the menu item.
- Press **Exit** to return video file list.

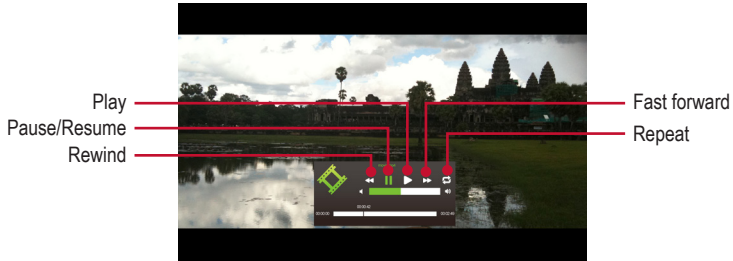

## Video Settings

### Enter Home Menu

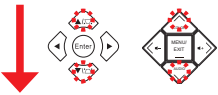
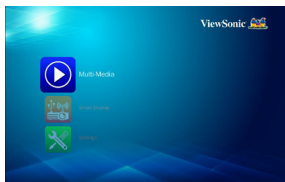

### Select [Settings]

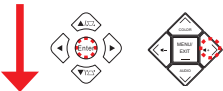
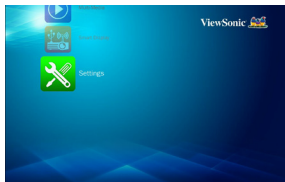

### Enter Settings Menu

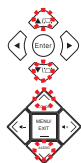
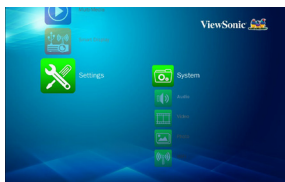

### Select [Video]

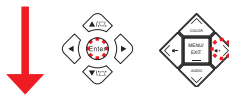
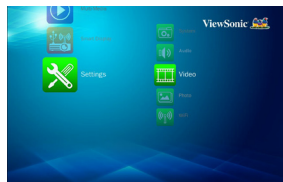

### Adjust Settings

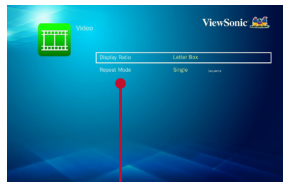

▲/▼: Select item

◀/▶: Adjust settings

#### Menu item      Description and Available Options

**Display Ratio**      Select the aspect ratio of the projected image.  
Available options: Letter Box / Cut screen / Full screen / Original screen

**Repeat Mode**      Set video play mode option.  
Available options: Single / Sequence

# Playing Music

To play music from the USB flash drive or SD card, do the following:

Enter Home Menu

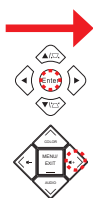
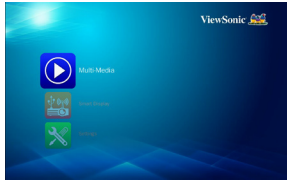

Select Data Source



Change data source



Select [Audio]

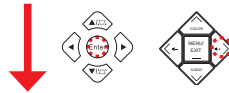
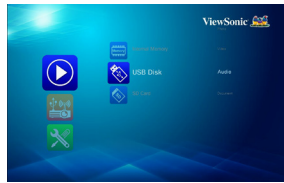

Select Audio File

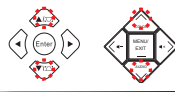

Playback File

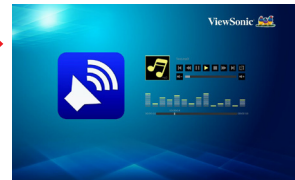

Music Playback mode

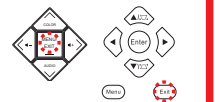

- The displayed screen may vary depending on the data source selected in the previous step.
- You can also press ► on the remote control to enter the submenu or confirm the selection.

# Music Playback Mode

**NOTE**

- During music playback, press  $\blacktriangleleft/\blacktriangleright$  on the remote control or  $\langle/\rangle$  on the control panel to adjust the volume.
- Press **Exit** to return music file list.

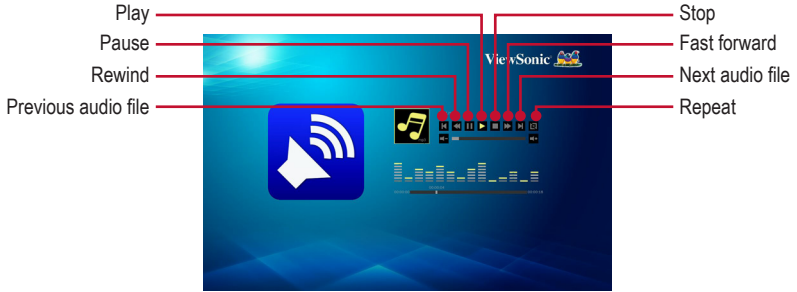

# Music Settings

## Enter Home Menu

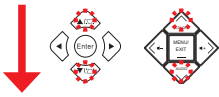
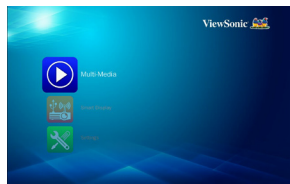

## Select [Settings]

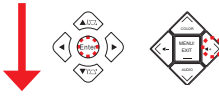
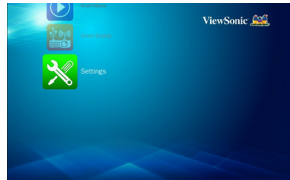

## Enter Settings Menu

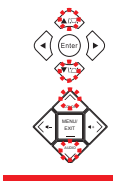
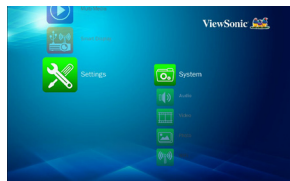

## Select [Audio]

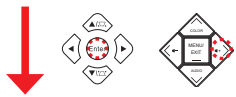
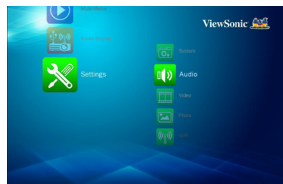

## Adjust Settings

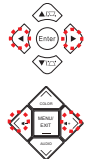
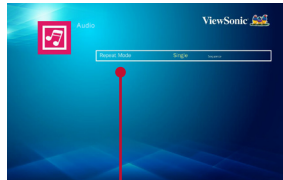

Menu item	Description and Available Options
Repeat Mode	Set music play mode option. Available options: Single / Sequence



# Viewing Documents

To view documents from the USB flash drive or SD card, do the following:

Enter Home Menu

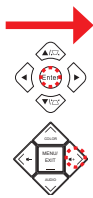
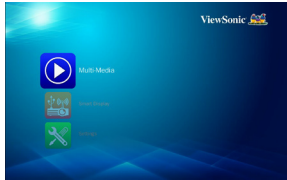

Select Data Source



Change data source



Select [Document]

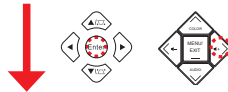

Select File

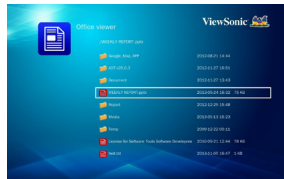
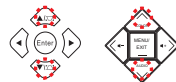

View File

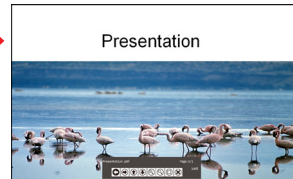

View mode

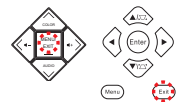

- The displayed screen may vary depending on the data source selected in the previous step.
- You can also press ► on the remote control to enter the submenu or confirm the selection.

## View Mode



- The button guide disappears when the keypad is not used for 3 seconds. To display the button guide, press any key.
- Use **◀/▶** to navigate between the button options.
- Press **Enter** to select the menu item.
- Press **Exit** to return document file list.

### Full screen view

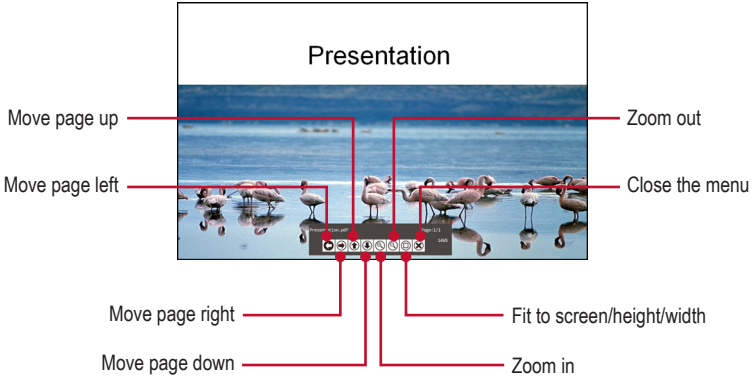

## Viewing System Settings

### Enter Home Menu

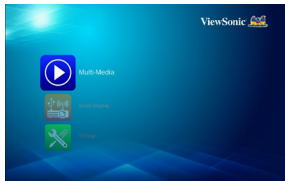

### Enter Settings Menu/Select [System]

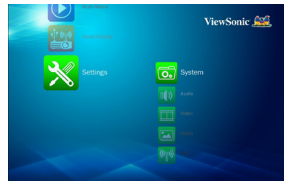

### Select [Settings]

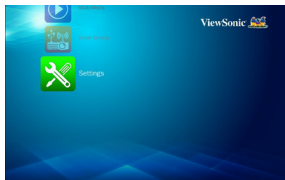

### Adjust Settings

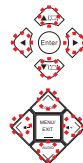
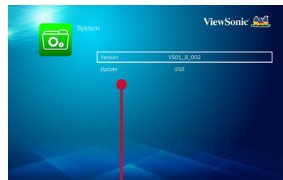

- ▲/▼: Select item
- ◀/▶: Adjust settings

Menu item	Description and Available Options
Version	Displays the firmware version.
Update	Allows you to update the firmware of the projector using a USB flash drive.

# USB Display

To project your computer screen, do the following:

NOTE

- When using USB Display function for the first time, install the software and execute:  
For Windows OS: vPresenter\_USB\_Win.exe.  
For Macintosh OS: vPresenter\_USB\_Mac-And-Driver-Installer.
- Extend display is not available on Windows 8/8.1.



## Enter Home Menu

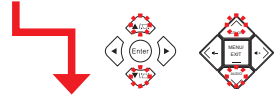

## Connect the USB cable

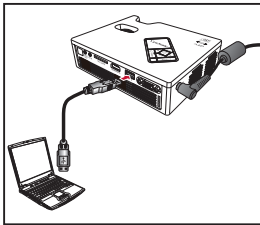

## Enter Smart Display Menu

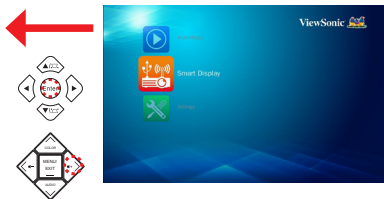
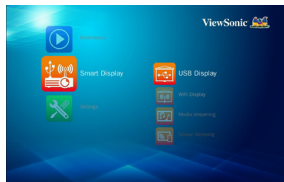

## Select [Smart Display]

## Select [USB Display]

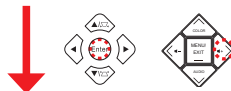

## Enter USB Display Page and perform USB Display software



## View PC Display



# Wi-Fi Display

When using Wi-Fi Display function for the first time, download and install the **vPresenter** application into your mobile device.

**NOTE**

- Download and install vPresenter application from **Play Store**, **APP Store**, or **PLED-W800 server**.
- Extend display is not available on Windows 8/8.1.



**Plug in the Wi-Fi Dongle**  
(Wi-Fi dongle is an optional accessory)

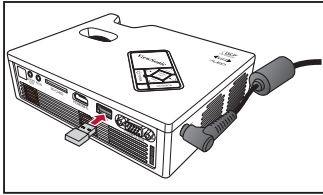

**Enter Home Menu**

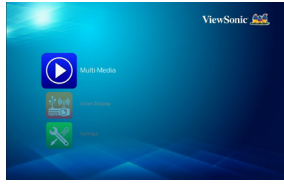

**Select [Smart Display]**

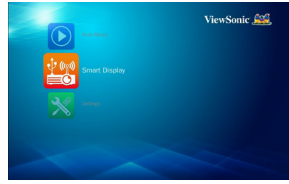

**Select [WiFi Display]**

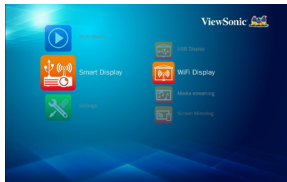

**Enter WiFi Display Page**



On your mobile device, enable Wi-Fi function and then select the dongle name listed in the Wi-Fi Network Connection list.

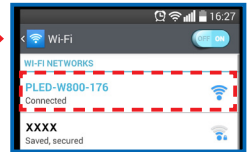

**Select the file to project.**



**Enter the Login Code as shown on the projected screen. Tap OK to continue.**

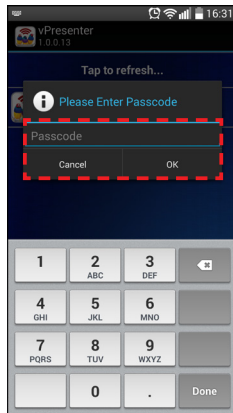

**Launch "vPresenter" application and select the projector name.**

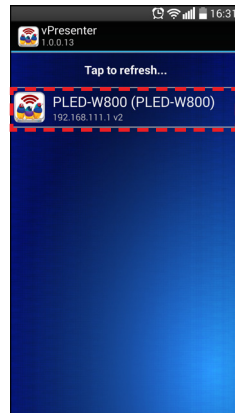

# Configure Wireless Connection (via AP mode)

To access the SmartDisplay on your device via AP mode connection, do the following:

## Plug in the Wi-Fi Dongle

(Wi-Fi dongle is an optional accessory)

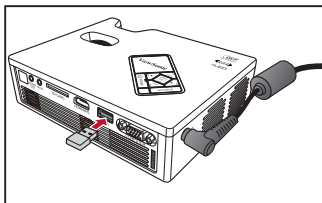

## Enter Home Menu

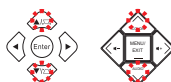
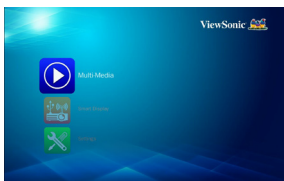

## Select [Settings]

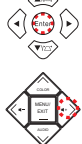
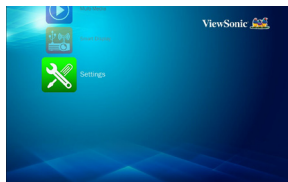

## Select [WiFi]

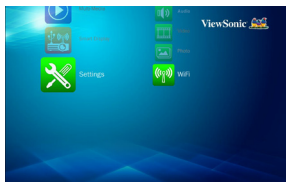

## Select [AP Mode]

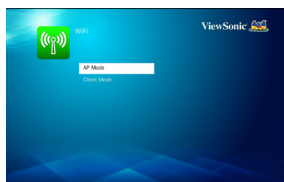

## Enter AP Mode Page. Select [ON] to enable the function.

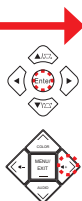
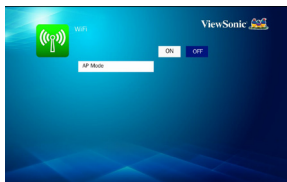

## Configure the settings. Then select OK to save the settings.

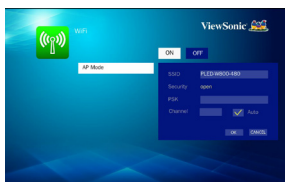

▲/▼/◀/▶: Select item  
Enter: Confirm

# Configure Wireless Connection (via Client mode)

To access the SmartDisplay on your device via Client mode connection, do the following:

## Plug in the Wi-Fi Dongle

(Wi-Fi dongle is an optional accessory)

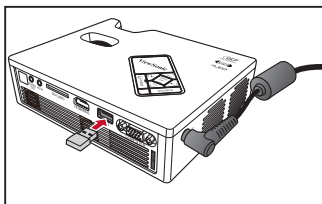

## Enter Home Menu

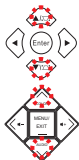
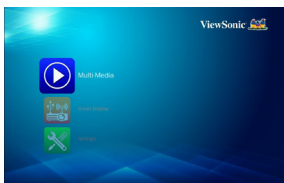

## Select [Settings]

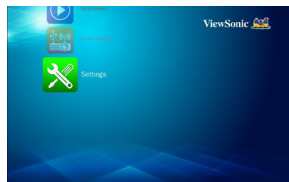

## Select [Wi-Fi]

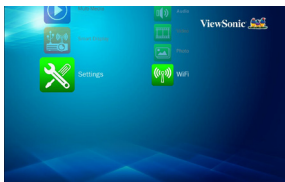

## Select [Client Mode]

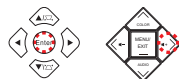
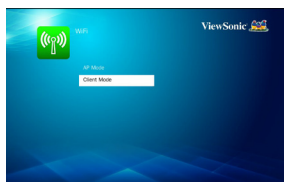

## Enter AP Mode Page. Select [ON] to enable the function.

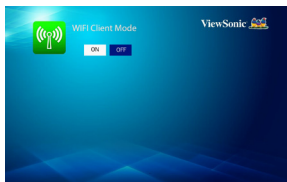

## Configure the settings. Then select OK to save the settings.

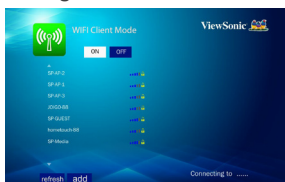

## Enter the password. Then select OK to save the settings.

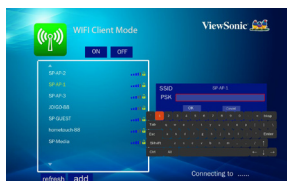

## Select the device to connect. Be sure to enable Hotspot function of your mobile device.



# Media Streaming

When using media streaming function for the first time, download and install the **BubbleUPnP** (Play Store) or **iMediaShare** (App Store) application into your mobile device.

Plug in the Wi-Fi Dongle

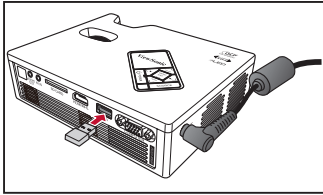

Enter Home Menu

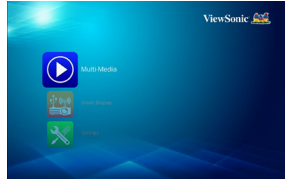

Select [Smart Display]

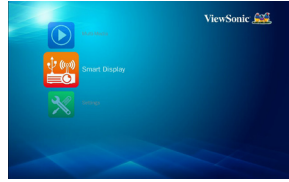

Select [Media streaming]

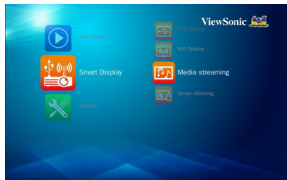

Enter Media Streaming Page

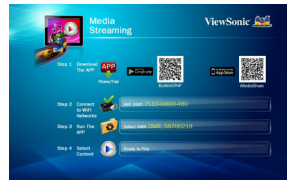

On your mobile device, enable Wi-Fi function and then select the dongle name listed in the Wi-Fi Network Connection list.

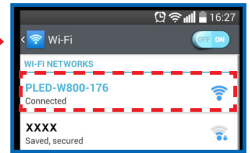

Select the media file to play.

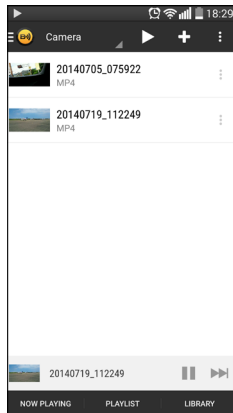

Launch "BubbleUPnP/iMediaShare" application and select the DMR name.

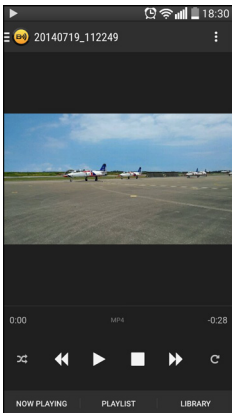
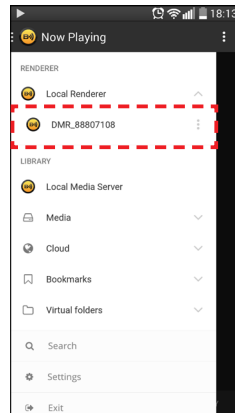

# Screen Mirroring

With Screen Mirroring function, you can mirror the compatible mobile device screen onto the projected screen wirelessly.

**NOTE**

- This function only works with compatible mobile devices that support Miracast, Media Output, or Screen Mirroring options.
- The configuration on the connection procedures vary depending on the mobile device UI design. Follow the instructions below to connect **LG Optimus G Pro** mobile phone to your projector.

## Plug in the Wi-Fi Dongle

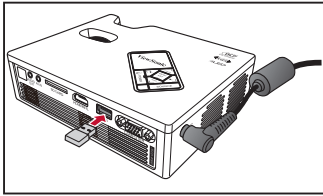

## Enter Home Menu



## Select [Smart Display]

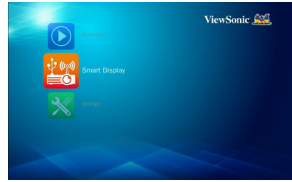

## Select [Screen Mirroring]

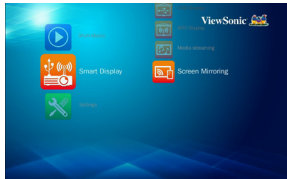

## Enter Screen Mirroring Page



On your mobile device, go to Settings > Share & connect. Be sure to enable Wi-Fi function of your mobile device.



Once connected, the mobile device display will be projected on the screen.

## Select the projector to connect.

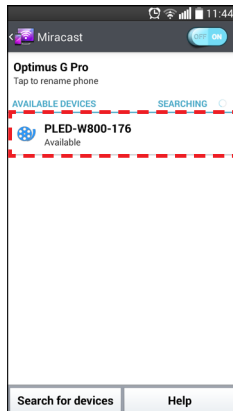

## Enable "Miracast" function.

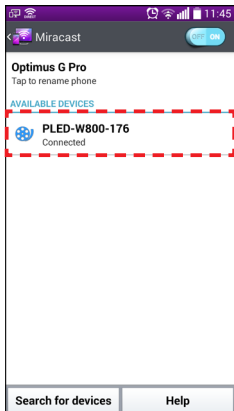
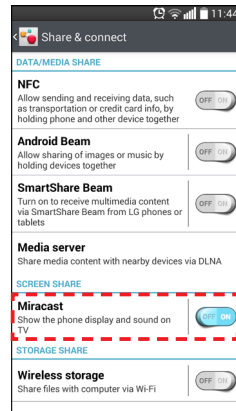



# Adjust Menu Settings for External Input Source

## Selecting Input Source

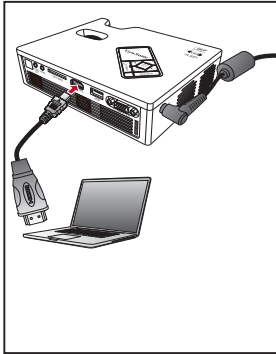

Once a video source device is connected and turned on, press **Source** on the remote control or **SOURCE** on the control panel to automatically switch the input source.

**Available sources are in the following order:**

1. HDMI/MHL
2. Video (PLED-W800 only)
3. COMPUTER (PLED-W800 only)
4. Media/USB (PLED-W800 only)



- *The last start position in the list is determined by the last connected input source.*

## Entering Menu Mode

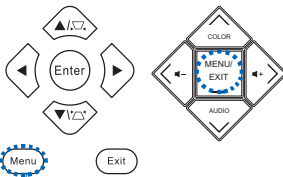

Press **Menu** on the remote control or **MENU** on the control panel to enter the menu mode.

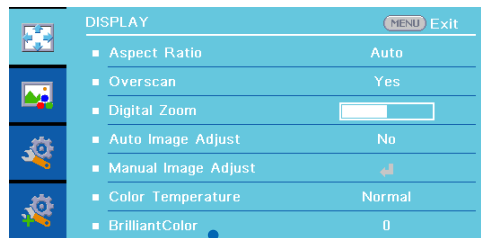

### Menu Operation

- |   |                  |             |                       |
|---|------------------|-------------|-----------------------|
| ▲ | Select main menu | ▶           | Enter current submenu |
| ▼ |                  | <b>Menu</b> | Hide OSD menu         |

### Submenu Operation

- |   |           |   |                |
|---|-----------|---|----------------|
| ▲ | Move up   | ◀ | Adjust setting |
| ▼ | Move down | ▶ |                |

## Menu Items (PLED-W800)

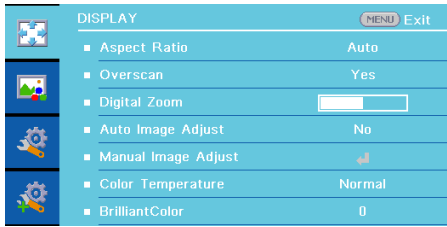

DISPLAY menu



PICTURE menu

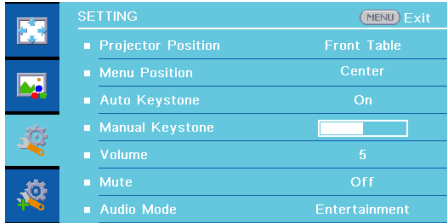

SETTING menu



OPTIONS menu

## Menu Items (PLED-W600)

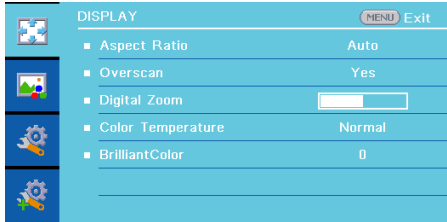

DISPLAY menu



PICTURE menu

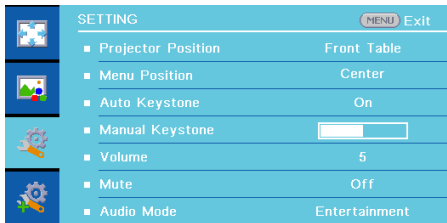

SETTING menu

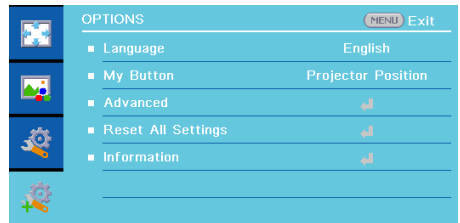

OPTIONS menu

# Using the Main Menu

Refer to the below table for details on menu items.



- Some of the menu options are not available on PLED-W600 projector.

Menu	Menu option	Description
DISPLAY	Aspect Ratio	Select the aspect ratio of the display. Available options: AUTO / 4:3 / 16:9 / 16:10
	Overscan	Enable overscan display (only for HDMI input signal). Available options: No / Yes
	Digital Zoom	Digitally enlarge the projected image. Available range: 0 ~ 10
	Auto Image Adjust	Synchronize the display automatically (only for COMPUTER input signal). Available options: No / Yes
		Adjust the PC display settings.
		Phase Adjust to reduce horizontal noise. Available range: 0 ~ 31
		Clock Adjust to reduce vertical noise. Available range: -5 ~ 5
	Manual Image Adjust	H. Position Move the screen position horizontally. Available range: -10 ~ 10
		V. Position Move the screen position vertically. Available range: -10 ~ 10
		Exit Return to the DISPLAY submenu.
	Color Temperature Select the preset color temperature. Available options: Warm / Normal / Cool	
	Brilliant Color Increase the brightness by changing the colors. Available range: 0~9	
PICTURE	Color Mode	Select a preset color mode. Available options: Brightest / PC / Movie / Dynamic / sRGB
	Brightness	Adjust the brightness of the image. Available range 0 ~ 100
	Contrast	Adjust the contrast of the image. Available range: 0 ~ 100
	Sharpness	Adjust the sharpness or softness of the image. Available range: 0 ~ 31
	Saturation	Adjust the color intensity (only for Video input signal). Available range: 0 ~ 100
	Tint	Adjust the balance of the red, green, and blue colors of the image (only for Video input signal). Available range: 0 ~ 100
		Set advanced settings for projected image.
		Gamma Adjust the color gamma differences between the dark and bright portions of the input signal. Available range: 0 ~ 7
	Advanced	Color Space Adjust the color for projected image from a video input signal. Available options: AUTO / RGB / YUV
		Pattern Select the pattern type to be displayed on the screen when there is no input signal. Available options: Off / 1 / 2 / 3 / 4 / 5
	Exit Return to the PICTURE submenu.	

Menu	Menu option	Description	
<b>SETTING</b>	Projector Position	Select the projector position. Available options: Front Table / Rear Table / Front Ceiling / Rear Ceiling	
	Menu Position	Set the display position of the OSD menu. Available options: Center / Top-Left / Top-Right / Bottom-Left / Bottom-Right	
	Auto Keystone	Automatically adjust the trapezoidal (keystone) distortion of the projected image. Available options: Off / On	
	Manual Keystone	Manually adjust the trapezoidal (keystone) distortion of the projected image. Available range: -40 ~ 40	
	Volume	Adjust the volume of the built-in speaker. Available range: 0 ~ 10	
	Mute	Temporarily turn off the sound. Available options: Off / On	
	Audio Mode	Select a preset audio mode. Available options: Default / Speech / Entertainment	
<b>OPTIONS</b>	Language	Set the on-screen display language. Available options: Arabic / Thai / Turkish / Traditional Chinese / Swedish / Russian / Korean / Italian / French / Spanish / Español / English / Deutschland / German	
	My Button	Specify the shortcut key. Available options: Projection Position / Brightness / Contrast / Color Temp / Menu Position / Information	
	Auto Search	Automatically detects the input signal when the projector is turned on. Available options: Off / On	
	Advanced	Configure other general settings.	
		Fan Mode	Set the fan speed according to altitude. Available options: AUTO / High Altitude
		Direct Power On	Turn on the projector power automatically when the power supply is switched on. Available options: Off / On
		Auto Power Off	Set the projector to automatically turn off if it is left idle at the preset time. Available options: Disable / 5 min / 10 min / 15 min / 20 min / 25 min / 30 min
		Exit	Return to the OPTIONS submenu.
	Reset All Settings	Reset all settings to the factory default settings. Available options: No / Yes	
	Information	Display the projector information.	

# Appendix

## Media File Support List (PLED-W800 only)

### Image

Image Format	Profile	Color Space	Size Limitation
JPEG	Baseline	YUV400	8000*6000
		YUV420	8000*6000
		YUV422	8000*6000
		YUV440	8000*6000
		YUV444	8000*6000
	Progressive	YUV400	Width <= 8000 & Height <= 6000
		YUV420	
		YUV422	
		YUV440	
BMP	No Limit	No Limit	8000*6000

### Audio

Audio Format	Sample Rate(KHz)	Bit Rate(Kbps)
MP1/MP2/MP3	8-48	8-320
WMA	22-48	5-320
OGG	8-48	64-320
ADPCM-WAV	8-48	32-384
PCM-WAV	8-48	128-1536
AAC	8-48	8-256

### Voice Record

File Format	Audio Format	Sample Rate(KHz)	Bit Rate (Kbps)
.mp3	MPEG Layer-3	8-48	64-256
.wav	IMA-ADPCM	8	32
		16	64
		24	192
		48	384

## Video

File Extensions	Audio/Video	Codec	Profile/Level Support	Explanation
.avi .divx .mkv	Video	MJPEG	Up to 1080P 30fps 80Mbps	
		H.264/AVC	Up to High Profile, Levels 1- 4.1 (1080P 30fps 25Mbps)	Support less than 6 reference frames Level Prefixparameter of CAVLCshould<=15
		DivX4/5/6	Up to Advance Simple profile (1080P 30fps 30Mbps)	Not supported scan type: interlaced Support GMC Less than 1 Warppoints
		XVID	Up to Advance Simple profile (1080P 30fps 30Mbps)	
		WMV3	Up to Main Profile	
		(WMV Ver9)	Low, Medium Level (1080P 30fps 25Mbps)	
		MPEG2	Main profile, Low and Main Levels (1080P 30fps 30Mbps)	Not support 1080i
		MPEG4	Advanced Simple Profile (frame picture) , Levels 0-5 (1080P 30fps 30Mbps)	
		VC-1	Simple and Main Pro- file; Low, Medium and High Levels (1080P 30fps 25Mbps)	Not Support VC-1 Advance Profile
	Audio	AC3		Not Support AC3-HD
		DTS		Not Support DTS-HD
		MPEG-1 Layer I, II		
		MPEG-1 Layer III (mp3)		
		PCM		
		ADPCM AAC		
.ts	Video	MPEG2	Main profile, Low and Main Levels (1080P 30fps 30Mbps)	Not support 1080i
		H.264/AVC	Up to High Profile, Levels 1- 4.1 (1080P 30fps 25Mbps)	Support less than 6 reference frames Level Prefixparameter of CAVLCshould<=15

File Extensions	Audio/Video	Codec	Profile/Level Support	Explanation
.ts	Audio	AC3		Not Support AC3-HD
		AAC	AAC-LC and HE-AAC	
		MPEG-1 Layer I, II		
		MPEG-1 Layer III (mp3)		
		DTS		Not Support DTS-HD
		LPCM		
.dat .vob .mpg .mpeg	Video	MPEG1	Main profile, Low and Main Levels (1080P 30fps 30Mbps)	D-picture not support
		MPEG2	Main profile, Low and Main Levels (1080P 30fps 30Mbps)	Not support 1080i
	Audio	MPEG-1 Layer I, II		
		MPEG-1 Layer III (mp3)		
		AC3		Not Support AC3-HD
		DTS		Not Support DTS-HD
.mov .mp4	Video	MPEG4	Advanced Simple Profile (frame picture), Levels 0-5 (1080P 30fps 30Mbps)	
		H.264/AVC	Up to High Profile, Levels 1- 4.1 (1080P 30fps 25Mbps)	Support less than 6 reference frames Level Prefixparameter of CAVLC should <=15
	Audio	AAC		
		AMR		
		PCM		
		ADPCM		
.rm .rmvb	Video	RV3	(1080P 30fps)	
		RV4	(1080P 30fps)	
	Audio	Cook(RA6)		
		RAAC(RA9) RACP(RA10)		
.wmv	Video	WMV3 (WMV Ver9)	Up to Main Profile; Low, Medium Level (1080P 30fps 25Mbps)	
	Audio	WMA2 (WMA Ver9 &Ver9.1)		Not Support WMA Ver9 Pro

## Subtitle

Format	Font	Subtitle Size
Standard SRT	UTF-8 / UTF-16	8bits up to 800*600
SMI		
SSA/ASS		



- DO NOT support mixed code in subtitle files.

## Picisel Office Viewer

File Format	Support Version	Pages/Lines Limitation	Size Limitation	Comment
Adobe PDF	PDF 1.0	Up to 1000 pages (One File)	Up to 75MB	
	PDF 1.1			
	PDF 1.2			
	PDF 1.3			
	PDF 1.4			
MS Word	British Word 95 Word 97, 2000, 2002, 2003	Because office viewer does not load all pages of MS Word file at the same time, there are no obvious limitations of page and line.	Up to 100MB	Not support Bold Text in Simple Chinese front
	Word 2007(.docx), 2010(.docx)			
MS Excel	British Excel 5, 95.	Row Limit: up to 595	Up to 15MB	Not support password-protected sheets
	Excel 97, 2000, 2002, 2003	Column Limit: up to 256		
	Excel 2007(.xlsx), 2010(.xlsx)	Sheet: up to 100		
	Office XP Excel	Note: Any one of three limitations above can not appear on one excel file simultaneously		
MS PowerPoint	British PowerPoint 97	Up to 1000 pages (One File)	Up to 19MB	No support SlideShow order
	PowerPoint 2000, 2002, 2003			
	PowerPoint 2007 (.pptx)			
	PowerPoint 2010 (.pptx)			
	Office XP PowerPoint			
	PowerPoint presentation- -2003 and earlier (.pps)			
PowerPoint presentation- -2007 and 2010 (.ppsx)				



## **Storage**

<b>Storage</b>	<b>Device type</b>	<b>File system</b>	<b>File&amp;Dir Level</b>
Internal Memory	TLC/MLC/SLC 8/12/24/40/60 bit ECC NAND	FAT16, FAT32	Support Max 999 directories and Max 9,999 Files
USB	USB Flash,USB-HardDisk	NTFS, ExFAT	Support atmost 10th level directory
SD Card	DHC,SDXC		

# Specifications

Model Name	PLED-W600	PLED-W800
Projection system	DLP®	
Resolution	WXGA (1280 x 800)	
Computer compatibility	IBM PC and compatibles, Apple Macintosh, iMac and VESA standards: SXGA, XGA, SVGA, VGA, WXGA	
Video compatibility	-	NTSC (3.58/4.43), PAL (B/D/G/H/I/M/N), SECAM (B/D/G/K/K1/L), HDTV (480i, 576i, 480p, 576p, 720p, 1080i, 1080p)
Aspect ratio	Auto, 4:3, 16:9, 16:10	
Displayable colors	1.07 billion colors	
Projection lens	F# 1.5, f = 13.92 mm	
Projection screen size	30" - 80" text 30"~100" video	
Projection distance	0.7 m – 3.0 m	
Throw ratio	1.4	
Horizontal scan rate	30 k - 100 kHz	
Vertical refresh scan rate	50 - 85 Hz	
Keystone correction	+/- 40 degrees	
Weight	0.79kg (1.74 lb)	0.83kg (1.83 lb)
Dimensions (W x D x H)	175mm (W) x 138mm (D) x 51.5mm (H) 6.89" (W) x 5.43" (D) x 2.03" (H)	
Power adaptor	AC input 100 - 240 V, 50 - 60 Hz	
	DC output: 19V, 3.42A	DC output: 19V, 4.74A
Power consumption	<65W	
	Standby: <0.5W	
Operating temperature	5°C to 35°C / 41°F to 95°F	
I/O connectors	<ul style="list-style-type: none"> <li>• DC Power socket x 1</li> <li>• USB A x 1 (service only)</li> <li>• HDMI/MHL x 1</li> <li>• Audio output x 1</li> </ul>	<ul style="list-style-type: none"> <li>• DC Power socket x 1</li> <li>• SD card reader x 1</li> <li>• USB A x 1</li> <li>• HDMI/MHL x 1</li> <li>• Computer x 1</li> <li>• A/V in x 1</li> <li>• Audio output x 1</li> </ul>
Accessories	<ul style="list-style-type: none"> <li>• Power Cord x1</li> <li>• Power Adaptor x1</li> <li>• HDMI cable x 1</li> <li>• Remote control x 1</li> <li>• AAA Batteries (for remote control) x 2</li> <li>• Soft carrying bag x 1</li> <li>• User's guide (CD) x 1</li> <li>• Quick start card x 1</li> </ul>	

# Troubleshooting

If you experience a problem with your projector, please refer to the following information. If a problem persists, please contact your local retailer or service center.

## Image Problems

☆ No image appears on-screen

- Ensure the power cord is correctly and securely connected.
- Ensure the pins of connectors are not crooked or broken.
- Make sure the projector is switched on.

☆ Image is out of focus

- Adjust the Focus Dial.
- Make sure the projection screen is between the required distance 0.72 to 3.02 meters (28.5in to 118.7in) from the projector.

☆ Image is too small or too large

- Move the projector closer to or further from the screen.

## Audio Problems

☆ No sound

- During music/video playback, press  $\llcorner$ -/ $\lrcorner$ + on the remote control or  $\langle$ / $\rangle$  on the control panel.



- *When the projector temperature reaches 85°C, the projector automatically shuts down due to the built-in temperature protection. This is not a malfunction. Let the projector cool down before switching it on again.*

# Customer Support

For technical support or product service, see the table below or contact your reseller.

**Note :** You will need the product serial number.

Country/Region	Website	T = Telephone C = CHAT ONLINE	Email
Australia New Zealand	www.viewsonic.com.au	AUS= 1800 880 818 NZ= 0800 008 822	service@au.viewsonic.com
Canada	www.viewsonic.com	T (Toll-Free)= 1-866-463-4775 T (Toll)= 1-424-233-2533	service.ca@viewsonic.com
Europe	www.viewsoniceurope.com	www.viewsoniceurope.com/uk/support/call-desk/	
Hong Kong	www.hk.viewsonic.com	T= 852 3102 2900	service@hk.viewsonic.com
India	www.in.viewsonic.com	T= 1800 266 0101	service@in.viewsonic.com
Korea	ap.viewsonic.com/kr/	T= 080 333 2131	service@kr.viewsonic.com
Latin America (Argentina)	www.viewsonic.com/la/	C= <a href="http://www.viewsonic.com/la/soporte/servicio-tecnico">http://www.viewsonic.com/la/soporte/servicio-tecnico</a>	soporte@viewsonic.com
Latin America (Chile)	www.viewsonic.com/la/	C= <a href="http://www.viewsonic.com/la/soporte/servicio-tecnico">http://www.viewsonic.com/la/soporte/servicio-tecnico</a>	soporte@viewsonic.com
Latin America (Columbia)	www.viewsonic.com/la/	C= <a href="http://www.viewsonic.com/la/soporte/servicio-tecnico">http://www.viewsonic.com/la/soporte/servicio-tecnico</a>	soporte@viewsonic.com
Latin America (Mexico)	www.viewsonic.com/la/	C= <a href="http://www.viewsonic.com/la/soporte/servicio-tecnico">http://www.viewsonic.com/la/soporte/servicio-tecnico</a>	soporte@viewsonic.com
Nexus Hightech Solutions, Cincinnati #40 Desp. 1 Col. De los Deportes Mexico D.F. Tel: 55) 6547-6454 55)6547-6484 Other places please refer to <a href="http://www.viewsonic.com/la/soporte/servicio-tecnico#mexico">http://www.viewsonic.com/la/soporte/servicio-tecnico#mexico</a>			
Latin America (Peru)	www.viewsonic.com/la/	C= <a href="http://www.viewsonic.com/la/soporte/servicio-tecnico">http://www.viewsonic.com/la/soporte/servicio-tecnico</a>	soporte@viewsonic.com
Macau	www.hk.viewsonic.com	T= 853 2870 0303	service@hk.viewsonic.com
Middle East	ap.viewsonic.com/me/	Contact your reseller	service@ap.viewsonic.com
Puerto Rico & Virgin Islands	www.viewsonic.com	T= 1-800-688-6688 (English) C= <a href="http://www.viewsonic.com/la/soporte/servicio-tecnico">http://www.viewsonic.com/la/soporte/servicio-tecnico</a>	service.us@viewsonic.com soporte@viewsonic.com
Singapore/ Malaysia/Thailand	www.viewsonic.com.sg	T= 65 6461 6044	service@sg.viewsonic.com
South Africa	ap.viewsonic.com/za/	Contact your reseller	service@ap.viewsonic.com
United States	www.viewsonic.com	T (Toll-Free)= 1-800-688-6688 T (Toll)= 1-424-233-2530	service.us@viewsonic.com

# Limited Warranty

## ViewSonic® Projector

### What the warranty covers:

ViewSonic warrants its products to be free from defects in material and workmanship, under normal use, during the warranty period. If a product proves to be defective in material or workmanship during the warranty period, ViewSonic will, at its sole option, repair or replace the product with a like product.

Replacement product or parts may include remanufactured or refurbished parts or components.

### Limited Three (3) year General Warranty

Subject to the more limited one (1) year warranty set out below, North and South America: Three (3) years warranty for all parts excluding the lamp, three (3) years for labor, and one (1) year for the original lamp from the date of the first consumer purchase.

Other regions or countries: Please check with your local dealer or local ViewSonic office for the warranty information.

### Limited One (1) year Heavy Usage Warranty:

Under heavy usage settings, where a projector's use includes more than fourteen (14) hours average daily usage, North and South America: One (1) year warranty for all parts excluding the lamp, one (1) year for labor, and ninety (90) days for the original lamp from the date of the first consumer purchase; Europe: One (1) year warranty for all parts excluding the lamp, one (1) year for labor, and ninety (90) days for the original lamp from the date of the first consumer purchase.

Other regions or countries: Please check with your local dealer or local ViewSonic office for the warranty information.

Lamp warranty subject to terms and conditions, verification and approval. Applies to manufacturer's installed lamp only. All accessory lamps purchased separately are warranted for 90 days.

### Who the warranty protects:

This warranty is valid only for the first consumer purchaser.

### What the warranty does not cover:

1. Any product on which the serial number has been defaced, modified or removed.
2. Damage, deterioration, failure, or malfunction resulting from:
  - a. Accident, abuse, misuse, neglect, fire, water, lightning, or other acts of nature, improper maintenance, unauthorized product modification, or failure to follow instructions supplied with the product.
  - b. Operation outside of product specifications.
  - c. Operation of the product for other than the normal intended use or not under normal conditions.
  - d. Repair or attempted repair by anyone not authorized by ViewSonic.
  - e. Any damage of the product due to shipment.
  - f. Removal or installation of the product.
  - g. Causes external to the product, such as electric power fluctuations or failure.
  - h. Use of supplies or parts not meeting ViewSonic's specifications.
  - i. Normal wear and tear.
  - j. Any other cause which does not relate to a product defect.
3. Removal, installation, one way transportation, insurance, and set-up service charges.

**How to get service:**

1. For information about receiving service under warranty, contact ViewSonic Customer Support (Please refer to Customer Support page). You will need to provide your product's serial number.
2. To obtain warranty service, you will be required to provide (a) the original dated sales slip, (b) your name, (c) your address, (d) a description of the problem, and (e) the serial number of the product.
3. Take or ship the product freight prepaid in the original container to an authorized ViewSonic service center or ViewSonic.
4. For additional information or the name of the nearest ViewSonic service center, contact ViewSonic.

**Limitation of implied warranties:**

There are no warranties, express or implied, which extend beyond the description contained herein including the implied warranty of merchantability and fitness for a particular purpose.

**Exclusion of damages:**

ViewSonic's liability is limited to the cost of repair or replacement of the product. ViewSonic shall not be liable for:

1. Damage to other property caused by any defects in the product, damages based upon inconvenience, loss of use of the product, loss of time, loss of profits, loss of business opportunity, loss of goodwill, interference with business relationships, or other commercial loss, even if advised of the possibility of such damages.
2. Any other damages, whether incidental, consequential or otherwise.
3. Any claim against the customer by any other party.
4. Repair or attempted repair by anyone not authorized by ViewSonic.

**Effect of state law:**

This warranty gives you specific legal rights, and you may also have other rights which vary from state to state. Some states do not allow limitations on implied warranties and/or do not allow the exclusion of incidental or consequential damages, so the above limitations and exclusions may not apply to you.

**Sales outside the U.S.A. and Canada:**

For warranty information and service on ViewSonic products sold outside of the U.S.A. and Canada, contact ViewSonic or your local ViewSonic dealer.

The warranty period for this product in mainland China (Hong Kong, Macao and Taiwan Excluded) is subject to the terms and conditions of the Maintenance Guarantee Card.

For users in Europe and Russia, full details of warranty provided can be found in [www.viewsoniceurope.com](http://www.viewsoniceurope.com) under Support/Warranty Information.

# Mexico Limited Warranty

## ViewSonic® Projector

### What the warranty covers:

ViewSonic warrants its products to be free from defects in material and workmanship, under normal use, during the warranty period. If a product proves to be defective in material or workmanship during the warranty period, ViewSonic will, at its sole option, repair or replace the product with a like product. Replacement product or parts may include remanufactured or refurbished parts or components & accessories.

### How long the warranty is effective:

3 years for all parts excluding the lamp, 3 years for labor, 1 year for the original lamp from the date of the first consumer purchase.

Lamp warranty subject to terms and conditions, verification and approval. Applies to manufacturer's installed lamp only.

All accessory lamps purchased separately are warranted for 90 days.

### Who the warranty protects:

This warranty is valid only for the first consumer purchaser.

### What the warranty does not cover:

1. Any product on which the serial number has been defaced, modified or removed.
2. Damage, deterioration or malfunction resulting from:
  - a. Accident, misuse, neglect, fire, water, lightning, or other acts of nature, unauthorized product modification, unauthorized attempted repair, or failure to follow instructions supplied with the product.
  - b. Any damage of the product due to shipment.
  - c. Causes external to the product, such as electrical power fluctuations or failure.
  - d. Use of supplies or parts not meeting ViewSonic's specifications.
  - e. Normal wear and tear.
  - f. Any other cause which does not relate to a product defect.
3. Any product exhibiting a condition commonly known as "image burn-in" which results when a static image is displayed on the product for an extended period of time.
4. Removal, installation, insurance, and set-up service charges.

### How to get service:

For information about receiving service under warranty, contact ViewSonic Customer Support (Please refer to the attached Customer Support page). You will need to provide your product's serial number, so please record the product information in the space provided below on your purchase for your future use. Please retain your receipt of proof of purchase to support your warranty claim.

For Your Records

Product Name: \_\_\_\_\_ Model Number: \_\_\_\_\_

Document Number: \_\_\_\_\_ Serial Number: \_\_\_\_\_

Purchase Date: \_\_\_\_\_ Extended Warranty Purchase? \_\_\_\_\_ (Y/N)

If so, what date does warranty expire? \_\_\_\_\_

1. To obtain warranty service, you will be required to provide (a) the original dated sales slip, (b) your name, (c) your address, (d) a description of the problem, and (e) the serial number of the product.
2. Take or ship the product in the original container packaging to an authorized ViewSonic service center.
3. Round trip transportation costs for in-warranty products will be paid by ViewSonic.

### Limitation of implied warranties:

There are no warranties, express or implied, which extend beyond the description contained herein including the implied warranty of merchantability and fitness for a particular purpose.

### Exclusion of damages:

ViewSonic's liability is limited to the cost of repair or replacement of the product. ViewSonic shall not be liable for:

1. Damage to other property caused by any defects in the product, damages based upon inconvenience, loss of use of the product, loss of time, loss of profits, loss of business opportunity, loss of goodwill, interference with business relationships, or other commercial loss, even if advised of the possibility of such damages.
2. Any other damages, whether incidental, consequential or otherwise.
3. Any claim against the customer by any other party.
4. Repair or attempted repair by anyone not authorized by ViewSonic.

<b>Contact Information for Sales &amp; Authorized Service (Centro Autorizado de Servicio) within Mexico:</b>	
<p><b>Name, address, of manufacturer and importers:</b>  México, Av. de la Palma #8 Piso 2 Despacho 203, Corporativo Interpalmas,  Col. San Fernando Huixquilucan, Estado de México  Tel: (55) 3605-1099 <a href="http://www.viewsonic.com/la/soporte/index.htm">http://www.viewsonic.com/la/soporte/index.htm</a></p>	
<b>NÚMERO GRATIS DE ASISTENCIA TÉCNICA PARA TODO MÉXICO: 001.866.823.2004</b>	
<p><b>Hermosillo:</b>  Distribuciones y Servicios Computacionales SA de CV.  Calle Juarez 284 local 2  Col. Bugambilias C.P: 83140  Tel: 01-66-22-14-9005  E-Mail: <a href="mailto:disc2@hmo.megared.net.mx">disc2@hmo.megared.net.mx</a></p>	<p><b>Villahermosa:</b>  Compumantenimientos Garantizados, S.A. de C.V.  AV. GREGORIO MENDEZ #1504  COL. FLORIDA C.P. 86040  Tel: 01 (993) 3 52 00 47 / 3522074 / 3 52 20 09  E-Mail: <a href="mailto:compumantenimientos@prodigy.net.mx">compumantenimientos@prodigy.net.mx</a></p>
<p><b>Puebla, Pue. (Matriz):</b>  RENTA Y DATOS, S.A. DE C.V. Domicilio:  29 SUR 721 COL. LA PAZ  72160 PUEBLA, PUE.  Tel: 01(52).222.891.55.77 CON 10 LINEAS  E-Mail: <a href="mailto:datos@puebla.megared.net.mx">datos@puebla.megared.net.mx</a></p>	<p><b>Veracruz, Ver.:</b>  CONEXION Y DESARROLLO, S.A DE C.V. Av. Americas  # 419  ENTRE PINZÓN Y ALVARADO  Frac. Reforma C.P. 91919  Tel: 01-22-91-00-31-67  E-Mail: <a href="mailto:gacosta@qplus.com.mx">gacosta@qplus.com.mx</a></p>
<p><b>Chihuahua</b>  Soluciones Globales en Computación  C. Magisterio # 3321 Col. Magisterial  Chihuahua, Chih.  Tel: 4136954  E-Mail: <a href="mailto:Cefeo@soluglobales.com">Cefeo@soluglobales.com</a></p>	<p><b>Cuernavaca</b>  Compusupport de Cuernavaca SA de CV  Francisco Leyva # 178 Col. Miguel Hidalgo  C.P. 62040, Cuernavaca Morelos  Tel: 01 777 3180579 / 01 777 3124014  E-Mail: <a href="mailto:aquevedo@compusupportcva.com">aquevedo@compusupportcva.com</a></p>
<p><b>Distrito Federal:</b>  QPLUS, S.A. de C.V.  Av. Coyoacán 931  Col. Del Valle 03100, México, D.F.  Tel: 01(52)55-00-00-27-35  E-Mail : <a href="mailto:gacosta@qplus.com.mx">gacosta@qplus.com.mx</a></p>	<p><b>Guadalajara, Jal.:</b>  SERVICRECE, S.A. de C.V.  Av. Niños Héroes # 2281  Col. Arcos Sur, Sector Juárez  44170, Guadalajara, Jalisco  Tel: 01(52)33-36-15-15-43  E-Mail: <a href="mailto:mmiranda@servicrece.com">mmiranda@servicrece.com</a></p>
<p><b>Guerrero Acapulco</b>  GS Computación (Grupo Sesiscomp)  Progreso #6-A, Colo Centro  39300 Acapulco, Guerrero  Tel: 744-48-32627</p>	<p><b>Monterrey:</b>  Global Product Services  Mar Caribe # 1987, Esquina con Golfo Pérsico  Frac. Bernardo Reyes, CP 64280  Monterrey N.L. México  Tel: 8129-5103  E-Mail: <a href="mailto:aydeem@gps1.com.mx">aydeem@gps1.com.mx</a></p>
<p><b>MERIDA:</b>  ELECTROSER  Av Reforma No. 403Gx39 y 41  Mérida, Yucatán, México CP97000  Tel: (52) 999-925-1916  E-Mail: <a href="mailto:rrb@sureste.com">rrb@sureste.com</a></p>	<p><b>Oaxaca, Oax.:</b>  CENTRO DE DISTRIBUCION Y  SERVICIO, S.A. de C.V.  Murguía # 708 P.A., Col. Centro, 68000, Oaxaca  Tel: 01(52)95-15-15-22-22  Fax: 01(52)95-15-13-67-00  E-Mail: <a href="mailto:gpotai2001@hotmail.com">gpotai2001@hotmail.com</a></p>
<p><b>Tijuana:</b>  STD  Av Ferrocarril Sonora #3780 L-C  Col 20 de Noviembre  Tijuana, Mexico</p>	<p><b>FOR USA SUPPORT:</b>  ViewSonic Corporation  14035 Pipeline Ave. Chino, CA 91710, USA  Tel: 800-688-6688 (English); 866-323-8056 (Spanish);  E-Mail: <a href="http://www.viewsonic.com">http://www.viewsonic.com</a></p>





ViewSonic®