

SC1000

Quick Installation Guide

07-2014 / v1.0

Edimax Technology Co., Ltd.

No.3, Wu-Chuan 3rd Road, Wu-Gu, New Taipei City 24891, Taiwan

Email: support@edimax.com.tw

Edimax Technology Europe B.V.

Fijenhof 2, 5652 AE Eindhoven, The Netherlands

Email: support@edimax.nl

Edimax Computer Company

3350 Scott Blvd., Bldg.15 Santa Clara, CA 95054, USA

Live Tech Support: 1(800) 652-6776

Email: support@edimax.com

I. Product Information

I-1. Package Contents

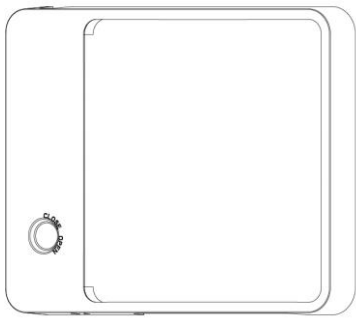

1

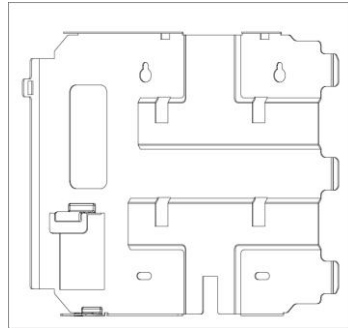

2

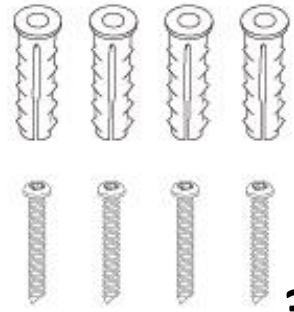

3

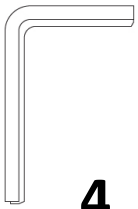

4

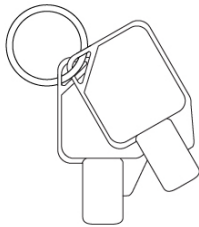

5



6

- 1.** Security Cover
- 2.** Mounting Bracket
- 3.** Screws

- 4.** Ejector Key
- 5.** Key
- 6.** QIG

I-2. Safety Information

The security cover is only for use with the following Edimax products:

- WAP1750
- WAP1200

The security cover should only be mounted to walls – not ceilings. Please note the following requirements for your security cover's location:



Do not attempt to fix the security lock to a ceiling or roof.



The security lock is for indoor use only.

1. Do not mount your security cover and WAP1750/1200 directly next to other electronic devices.
2. Do not mount on uneven, slanted or unstable walls.
3. Do not mount in any location subject to direct sunlight, heat sources or electromagnetic waves.
4. Do not mount in any location subject to condensation or water.
5. Do not mount in any location with temperatures outside the range 0°C to 50°C.
6. Ensure that your security cover is secured firmly to the wall and installed according to these instructions.

II. Assembly

1. Fix the mounting bracket to the wall using the included screws.

 **Drill holes and use the included wall-mounting anchors if you need.**

Ensure the mounting bracket is positioned the correct way up, according to the picture:

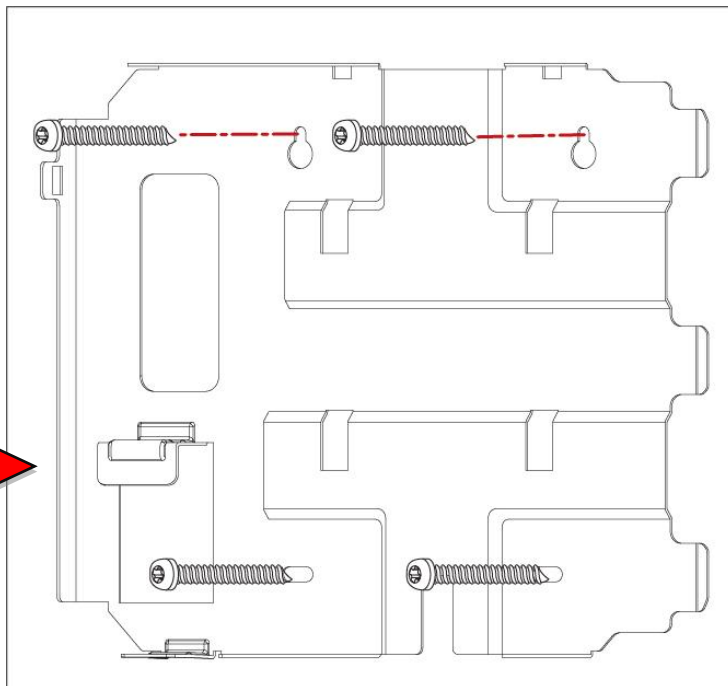

2. Press your WAP1750/1200 (oriented with the antennas at the bottom) into the bracket and slide downwards to click into position.

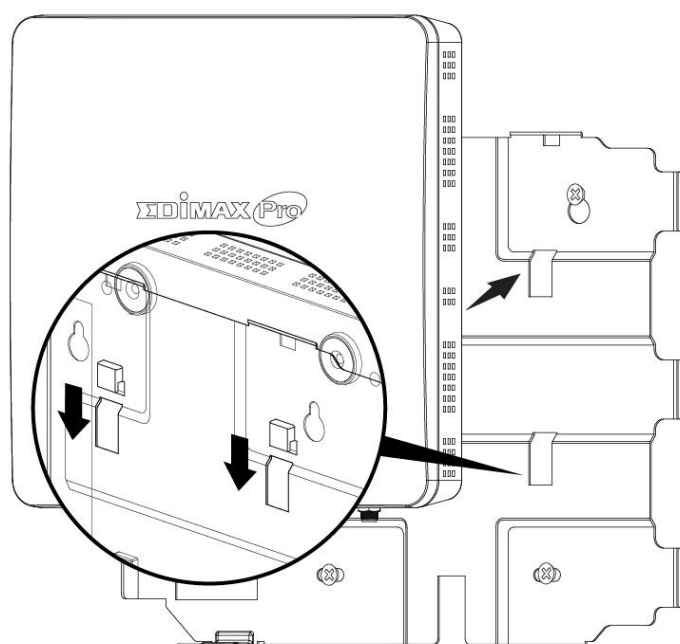

- 3.** Turn the security cover lock to the “Open” position using the key, and push the right-side of the security cover into position first. With the right-side in place, push the left-side down to secure the cover firmly in position.

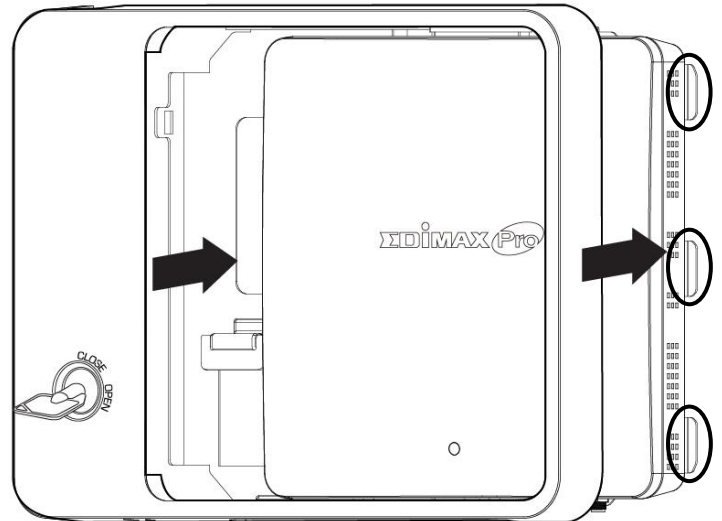

- 4.** Turn the lock to “Close” and remove the key.

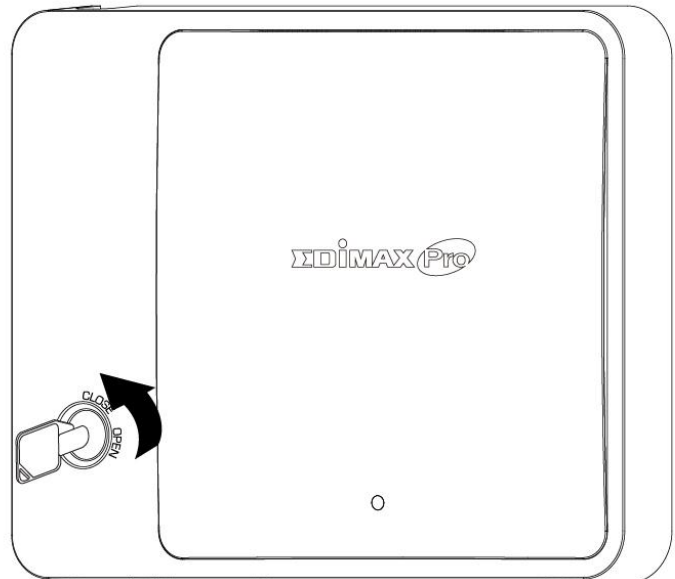

III. Removing the Security Cover

- 1.** To remove the security cover, insert the included ejector key behind the WAP1750/1200 to unhook the locking clip, as shown below. Slide the WAP1750/1200 up to remove.

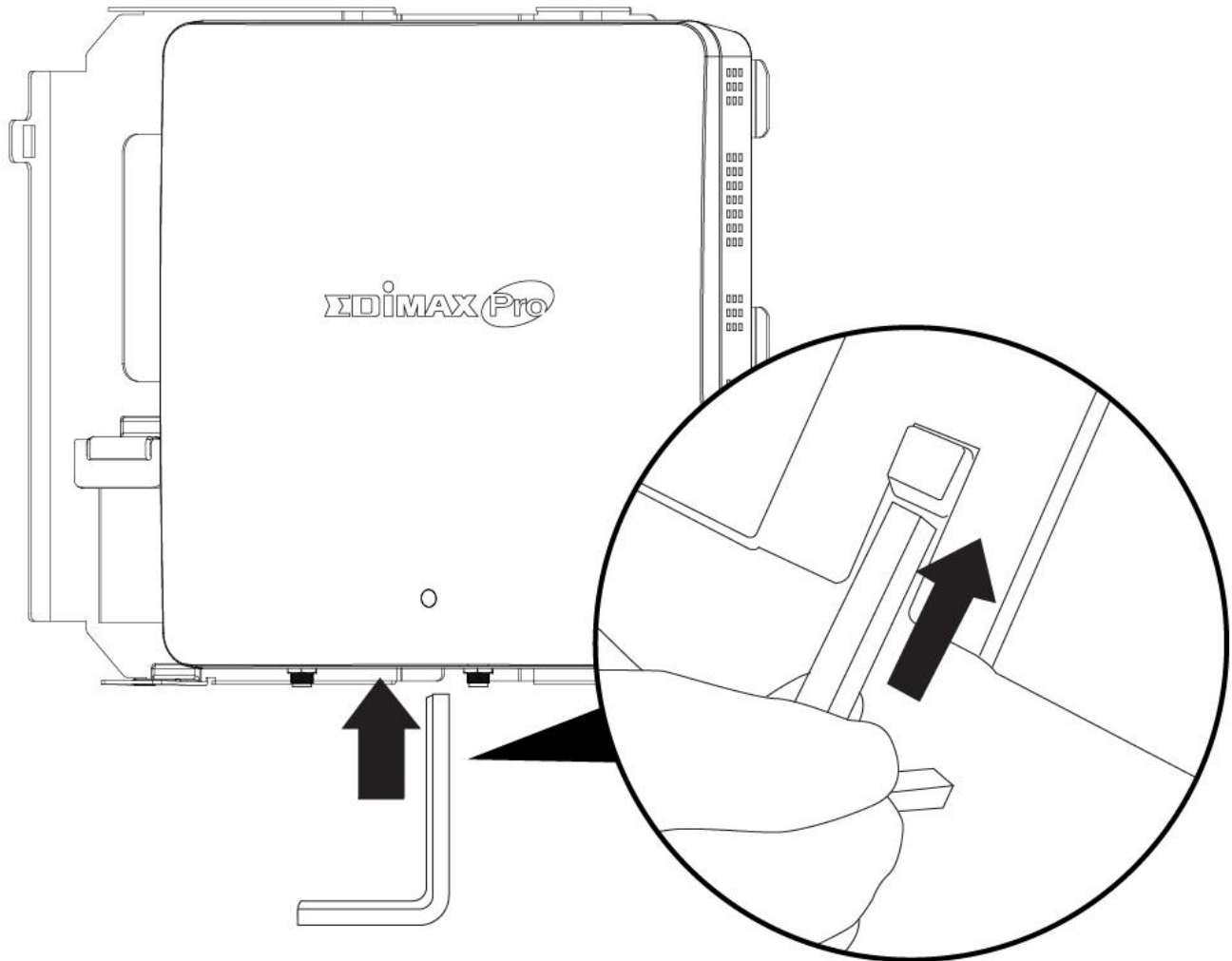



EDIMAX
NETWORKING PEOPLE TOGETHER